



# Installation, Use and Maintenance Manual for model

---

## R2KA 24 /40

---

Condensing boiler with integrated heat  
exchanger for domestic hot water side  
and storage

CE 0476

R2KA 24 /40 - RAD - ING - Manuale - 1806.1\_SK.2



## SUMMARY

INTRODUCTION	4
--------------	---

## 1. INSTALLER SECTION 7

1.1. INSTALLATION	8
1.1.1. GENERAL INSTALLATION WARNINGS	8
1.1.2. BOILER LOCATION ENVIRONMENTAL REQUIREMENTS	8
1.1.3. REFERENCE LEGISLATION	9
1.1.4. UNPACKING	10
1.1.5. OVERALL DIMENSIONS	11
1.1.6. JIG	11
1.1.7. MINIMAL TECHNICAL SPACES	12
1.1.8. CIRCULATOR PREVALENCE/FLOW DIAGRAM	13
1.1.9. HYDRAULIC CONNECTION	14
1.1.10. D.H.W. CIRCULATING LOOP	15
1.1.11. SYSTEM FILLING	16
1.1.12. FILLING THE CONDENSATE COLLECTION SIPHON	17
1.1.13. ANTI-FREEZE PROTECTION	18
1.1.14. GAS CONNECTION	19
1.1.15. ELECTRICAL CONNECTION	19
1.1.16. POWER SUPPLY	20
1.1.17. OPTIONAL ELECTRICAL CONNECTIONS	21
1.1.18. FUME EXHAUST FITTINGS	23
1.1.19. INSTALLATION MODES	24
1.1.20. TYPES OF FUME EXHAUST SYSTEMS	26

## 2. SUPPORT CENTRE SECTION 29

2.1. FIRST START-UP	30
2.1.1. PRELIMINARY OPERATIONS FOR FIRST START-UP	30
2.1.2. BOILER COMMISSIONING	31
2.1.3. CO <sub>2</sub> VALUE CHECK AND CALIBRATION	32
2.1.4. ACCESSING AND PROGRAMMING THE PARAMETERS	33
2.1.5. DIGITECH CS PARAMETERS TABLE	35
2.1.6. ELECTRIC FAN FREQUENCY/HEAT CAPACITY DIAGRAM	42
2.2. MAINTENANCE	43
2.2.7. GENERAL MAINTENANCE WARNINGS	43
2.2.8. TECHNICAL DATA	45
2.2.9. TECHNICAL ASSEMBLY	50
2.2.10. HYDRAULIC BOARD	51
2.2.11. 3-WAY VALVE OPERATION	52



2.2.12. WIRING DIAGRAM.....	53
2.2.13. ACCESSING THE BOILER.....	54
2.2.14. ACCESSING THE ELECTRONIC BOARD.....	55
2.2.15. SYSTEM EMPTYING.....	56
2.2.16. BOILER MAINTENANCE.....	57
2.2.17. FAULT SIGNALLING CODES.....	58
2.2.18. ACTIVE FUNCTIONS SIGNALLING CODES.....	61
2.2.19. GAS TYPE TRANSFORMATION.....	62

## 3. USER SECTION 63

3.1. USE.....	64
3.1.1. GENERAL USE WARNINGS.....	64
3.1.2. CONTROL PANEL.....	65
3.1.3. DISPLAY ICONS.....	66
3.1.4. INFO MENU DISPLAY DATA.....	67
3.1.5. START-UP.....	68
3.1.6. OPERATING MODE.....	68
3.1.7. INFORMATIONAL NOTE ON ANTI-FREEZE FUNCTION.....	69
3.1.8. SYSTEM FILLING.....	70
3.1.9. FAULT SIGNALLING CODES.....	71
3.1.10. ACTIVE FUNCTIONS SIGNALLING CODES.....	73
3.1.11. MAINTENANCE.....	74
3.1.12. COVER CLEANING.....	74
3.1.13. DISPOSAL.....	74

## INTRODUCTION

### WARNING

Before starting any operation it is mandatory to read this instruction manual, in relation to the activities to be carried out as described in each relevant section. Proper operation and optimal performance of the boiler are ensured by strict compliance with all the instructions given in this manual.

The installation, use and maintenance manual is an integral and essential part of the product and must be delivered to the user.

### MANUAL USERS

The manual users are all those who install, use and maintain the boiler.

The boiler must be used and accessed only by qualified operators that fully read and understood the use and maintenance manual, paying particular attention to the warnings.

### READING AND SYMBOLS OF THE MANUAL

To ease the understanding of this manual, recurrent symbols where used, in particular:

- › On the outer margin of the page is placed a thumb index indicating the type of user to which the instructions in that section address.
- › The titles are differentiated by thickness and size in accordance with their hierarchy.
- › The images contain important parts described in the text, marked with numbers or letters.
- › (See chap “chapter name”): this entry indicates another section in the Manual that you should refer to.
- › Device: this term is used referring to the boiler.



### DANGER

*It identifies an information related to a general danger that if not complied with, may cause serious personal damage or even death.*



### ATTENTION

*It identifies an information that if not complied with may cause small or medium level lesions to the person or serious deterioration to the boiler.*



### WARNING

*It identifies a precaution information that must be observed in order to avoid damaging the machine or parts of it.*

### MANUAL STORAGE

The manual must be carefully stored and replaced in case of deterioration and/or low legibility.

If you misplace the use and maintenance manual, you can request it from the Technical Support Centre giving the serial number and model of the boiler indicated on the plate placed on the right side of its casing.

As an alternative, the use and maintenance manual can be downloaded free from the on-line site [www.radiant.it](http://www.radiant.it), accessing the “download” section and entering the boiler model.



## MANUFACTURER WARRANTY AND RESPONSIBILITY

The warranty of the Manufacturer is provided only through its own authorized Technical Support Centres, listed for each Region and Province on the site [www.radiant.it](http://www.radiant.it), and covers all conformity defects at the moment of sale.

The technical and functional features of the device are ensured by its use in compliance:

1. with the use and maintenance instructions contained in the manuals accompanying the product, the content of which the customer certifies that he is aware;
2. with the conditions and purposes to which assets of the same type are intended.

For more information on the warranty validity, its duration, the obligations and the exemptions, please consult the First start-up certificate attached to this manual.

The manufacturer reserves:

- › the right to modify the tools and relative technical documentation without any obligation to third parties; neither will the company be held responsible for any inaccuracies in this handbook deriving from printing or translation errors;
- › the material and intellectual ownership of this manual and forbids its distribution and duplication, even partial, without prior written authorization.

## PRODUCT CONFORMITY

RADIANT BRUCIATORI spa declares that its gas boilers comply with the European Directives and with the requirements provided in the European standards below:

- › Energy labeling Directive 2010/30/CE,
- › EU regulation 811/2013,
- › EU regulation 813/2013,
- › Gas Directive 2009/142/CE,
- › Electromagnetic compatibility Directive 2014/30/CE,
- › Performance Directive 92/42/CE,
- › Low voltage Directive 2014/35/CE.

The materials used such as copper, brass, stainless steel create a homogeneous, compact and functional assembly, easy to install and manage. In its simplicity, the boiler is equipped with all accessories necessary to render it a veritable independent heating unit. All boilers are tested and delivered with a quality certificate signed by the tester.





# 1. INSTALLER SECTION

The installation operations described in this section should be performed only by qualified personnel, having the appropriate technical training in the field for the installation and maintenance of components of civil and industrial domestic hot water production and heating plants.



## 1. INSTALLATION

### 1.1. INSTALLATION

#### 1.1.1. GENERAL INSTALLATION WARNINGS



##### ATTENTION

*This machine may be used only for the purpose for which it has been designed: heat water to a temperature below boiling point at atmospheric pressure. Any other use is considered wrong and dangerous. The manufacturer is excluded from any contractual or out of contract responsibility for damage caused to people, animals or property due to errors during installation.*



##### ATTENTION

*This boiler should be installed only by qualified personnel, having the appropriate technical training in the field for the installation and maintenance of components of civil and industrial domestic hot water production and heating plants.*



##### ATTENTION

*After having removed the packing, make sure the equipment is intact. In case of doubt, do not use the equipment and contact the supplier.*

**BEFORE INSTALLING THE BOILER, THE INSTALLER MUST MAKE SURE THAT THE FOLLOWING CONDITIONS ARE MET:**

- › The device is connected to a heating plant and a water supply network appropriate for its power and performance.
- › The location must be properly vented through an air vent.
- › The air vent must be placed at floor level to prevent it from being obstructed, protected by a grid that does not hamper the useful section of passage.

- › The device is suitable for use with the type of gas available by checking the boiler data plate (placed on the inner side of the front casing).
- › Make sure that the tubes and couplings are perfectly sealed, without any gas leaks.
- › Make sure that the grounding system works properly.
- › Make sure that the electrical systems is suitable for the maximum power absorbed by the equipment, value indicated on the data plate.



##### WARNING

*Use only original RADIANT optional or kit accessories (including electrical).*

#### 1.1.2. BOILER LOCATION ENVIRONMENTAL REQUIREMENTS

The device's installation location should be vented due to the presence of threaded joints on the gas adduction line. The location should be therefore provided with vents as to ensure air exchange, with output grid in the natural accumulation area of eventual gas losses.



##### WARNING

*DO NOT install the boiler in a technical compartment near a swimming pool or a laundry, to avoid that the combustion air is exposed to chlorine, ammonia or alkaline agents that may worsen the corrosion phenomenon of the heat exchanger. Failure to observe this caution will void the warranty of the heat exchanger.*



**WARNING**

*If the temperature in the boiler installation location goes below -10° centigrades, please fill the plant with anti-freeze liquid and insert and electrical resistances kit (see chapter 'ANTI-FREEZE PROTECTION').*

**WARNING**

*The manufacturer will not be held responsible for damages caused by incorrect installation not in conformity with the over mentioned instructions and not protected adequately from the freeze.*

### 1.1.3. REFERENCE LEGISLATION

The installation must be realized according to the requirements of current legislation and in compliance with local technical regulations, according to the indications of the good technique.



## 1. INSTALLATION

### 1.1.4. UNPACKING



#### WARNING

*Please unpack the boiler just before installing it. The Company is not responsible for the damages caused to the device due to incorrect storage.*



#### WARNING

*The packing elements (cardboard box, wooden crate, nails, fasteners, plastic bags, expanded polystyrene, etc.) must be kept out of the reach of children as they may be dangerous. Therefore they should be dismantled suitably differentiating them in accordance with the standards in force.*

To unpack the boiler, proceed as follows:

- > cut the fixing strip (see A-fig.1);
- > remove the cardboard box lifting it upwards (see B-fig.1);
- > push the boiler on one side and remove the pallet underneath (see C-fig.1).

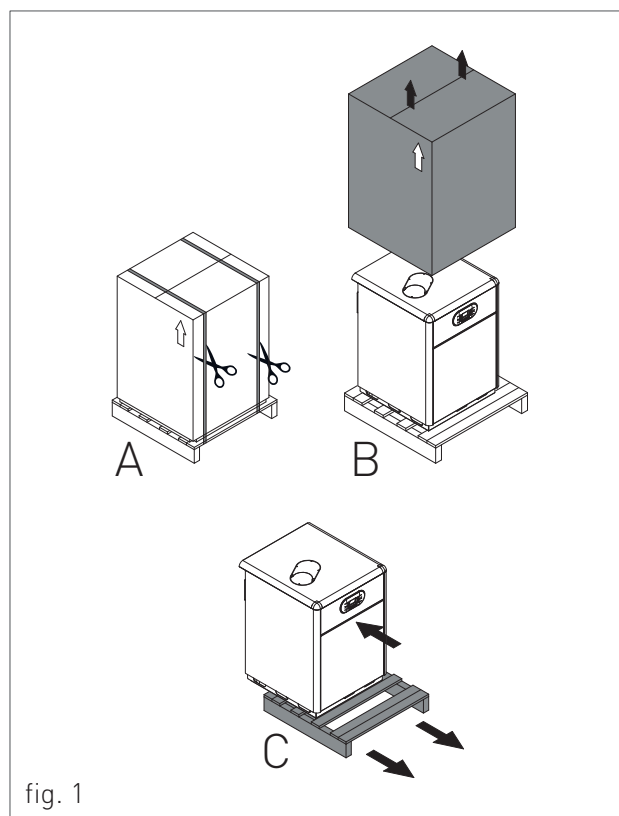
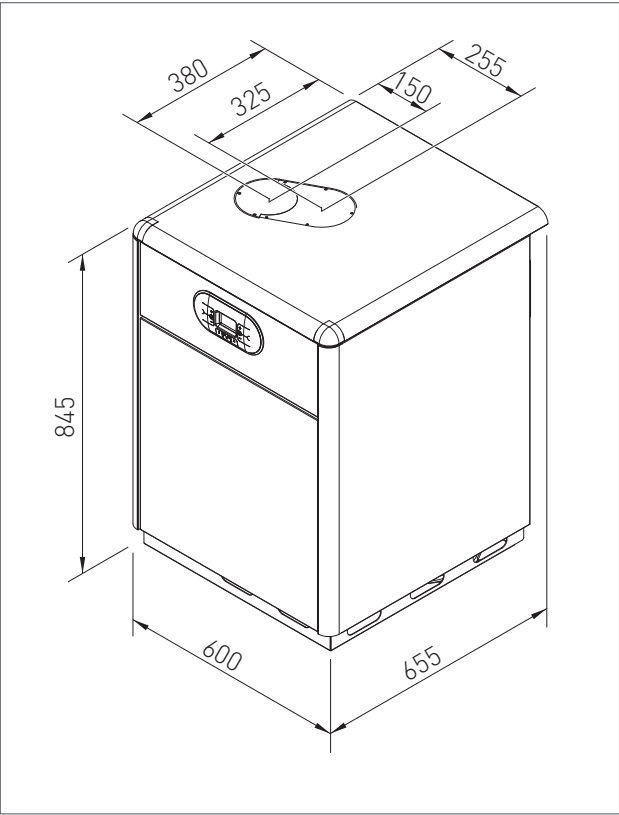

fig. 1



1.1.5. OVERALL DIMENSIONS



1.1.6. JIG

R-	HEATING RETURN	Ø 3/4	SVS-	SAFETY
C-	HOT	Ø 3/4		DRAIN
G-	GAS	Ø 3/4		VALVE
F-	COLD	Ø 3/4		
A-	HEATING FLOW	Ø 3/4		
RC-	D.H.W. CIRCULATING LOOP	Ø 1/2		

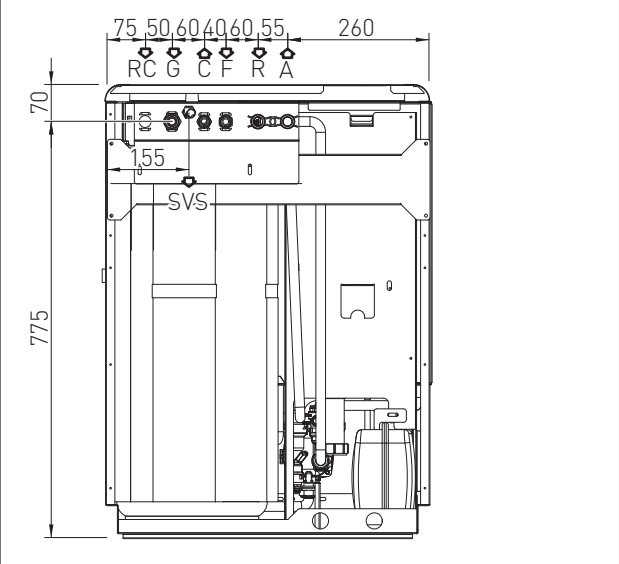



## 1. INSTALLATION

### 1.1.7. MINIMAL TECHNICAL SPACES

The appliance must be installed exclusively on a flat horizontal solid floor capable of supporting its weight.

In order to allow the access inside the boiler for maintenance operations, you have to respect the minimum technical spaces indicated in figure 1.

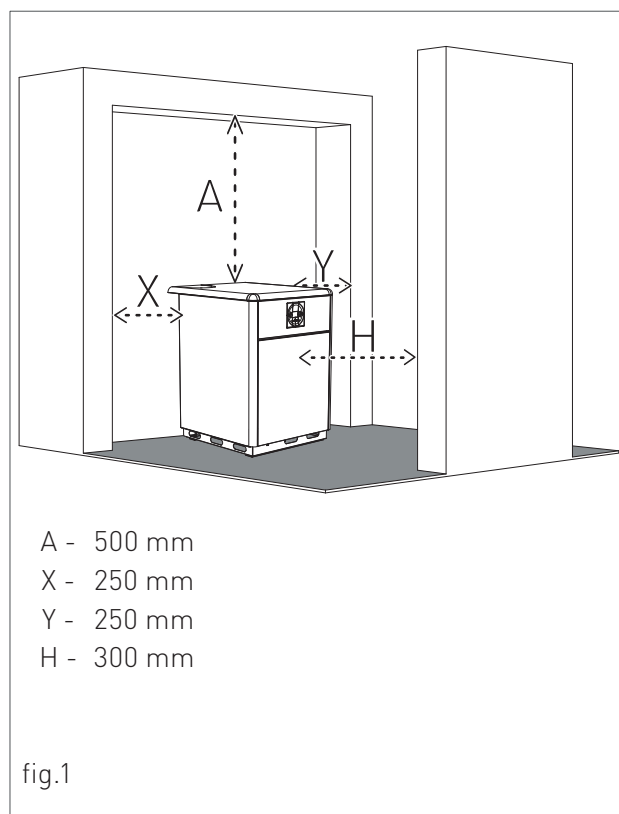



1.1.8. CIRCULATOR PREVALENCE/  
FLOW DIAGRAM

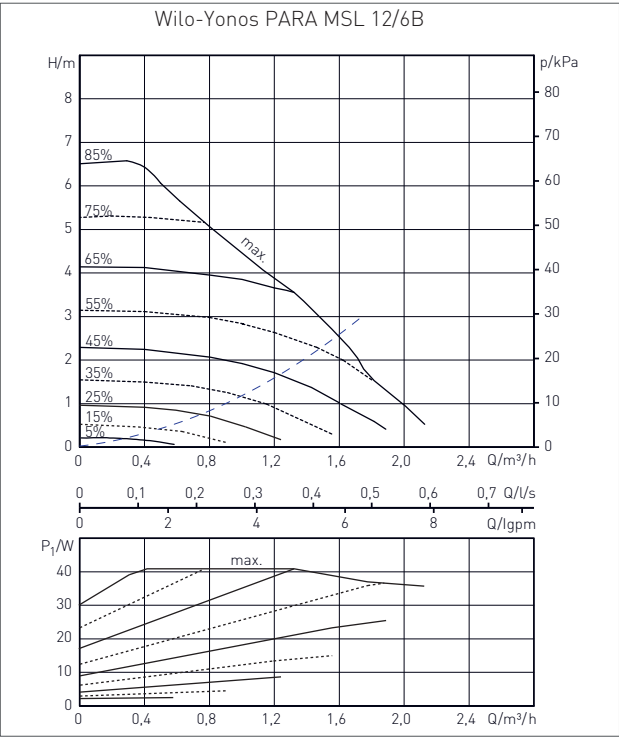

--- Appliance Loss



## 1. INSTALLATION

### 1.1.9. HYDRAULIC CONNECTION



#### **DANGER**

*Make sure that the tubes of the water and heating plant are not used as grounding system for the electrical plant. There are not suitable for such use.*



#### **WARNING**

*To prevent voiding the warranty and to ensure the proper operation of the boiler, please wash the plant (if possible when hot) with suitable pickling or descaling solutions in order to remove the impurities coming from tubes and radiators.*



#### **WARNING**

*If the boiler is installed in a hydrostatic position lower than those of the user devices (radiators, fan coils, etc.), mount the shut-off valves on the domestic water heating circuit to ease the performance of the maintenance operations if it is necessary only to empty the boiler.*



#### **WARNING**

*When connecting the equipment to water supply, avoid excessive bending and recovery operations from any off axis positioning that may damage the tubes causing leaks, malfunction or early wear.*



#### **WARNING**

*In order to avoid any vibrations and noises, do not use tubes with small diameters or elbows with small radius and significant cut-off of the passage sections.*



#### **WARNING**

*Connect the boiler safety drains to a discharge funnel. The manufacturer is not responsible for any floods due to safety valve opening in case of plant overpressure.*

### DOMESTIC CIRCUIT

In order to prevent limestone build-up and damages to the domestic water heat exchanger, the hardness of the domestic supply water should not exceed 15 °f. However, please check the characteristics of the water used and install suitable treating devices.

The heat exchanger coil cleaning frequency depends on the hardness of the supply water and on the presence of solid residues or impurities inside the water that are often present in case of recently installed plants. Based on the characteristics of the infeed water, you should install suitable water treating devices, for residues presence please install a line filter.

The pressure of the cold infeed water should be between 0.5 and 6 bar. In case of greater pressure values, please install a pressure reducer upstream from the boiler.

### HEATING CIRCUIT

In order to avoid any scale or deposits on the primary exchanger, the hardness of the heating circuit infeed water should not exceed 25 °f. However, please check the characteristics of the water used and install suitable treating devices.

This treatment is mandatory if frequent episodes of return water or partial or total emptying of the plant occur.



#### **WARNING**

*In case the boiler is installed as part of a low temperature circuit, please install a safety thermostat on the heating flow, which can stop the boiler activity in case of high heating flow temperature. The company assumes no liability for damage caused to persons or for failure to comply with these instructions.*

### 1.1.10. D.H.W. CIRCULATING LOOP

In order to joint the D.H.W out loop pipe, proceed as follows:

- › unscrew the 1/2" cap (A-fig.1), placed on the front side of the cylinder;
- › joint the nipple to the D.H.W. circulating pipe.

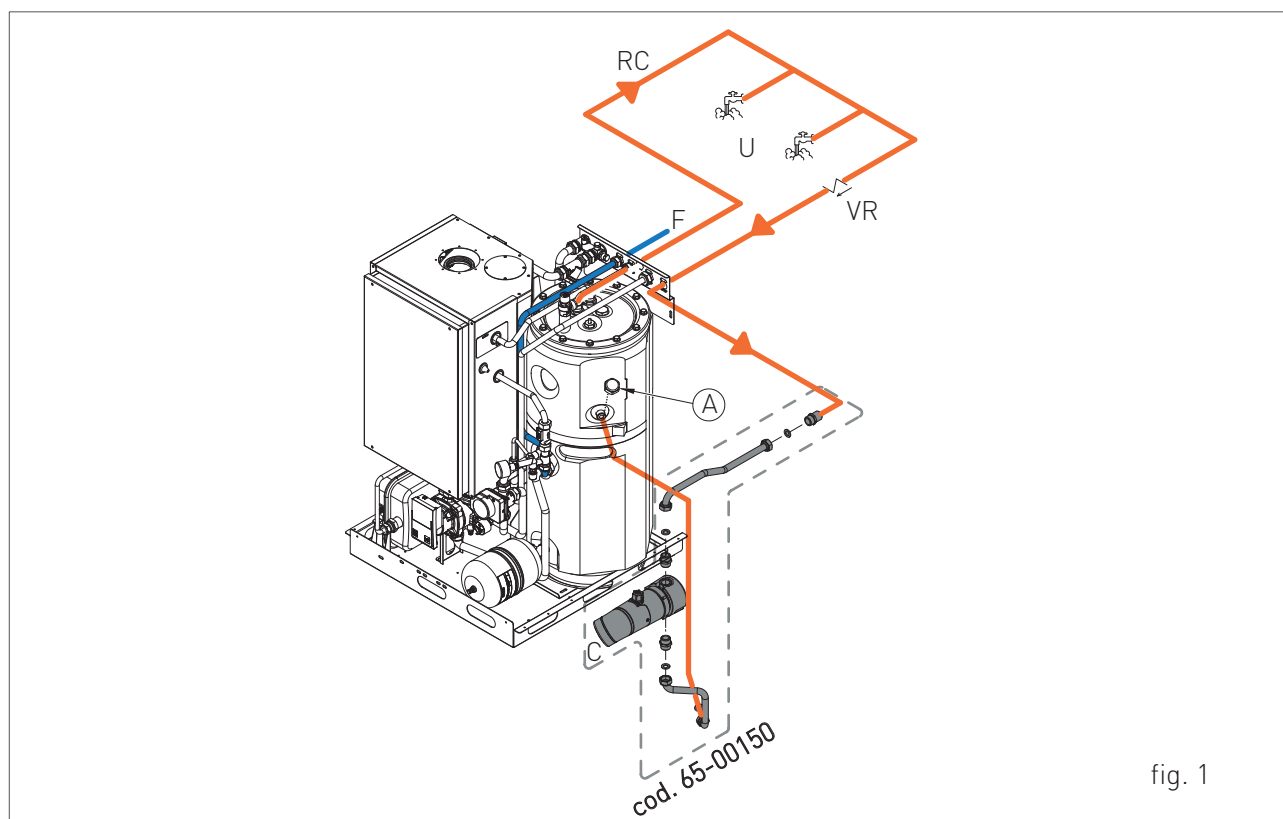

#### KEY

- RC- D.H.W. CIRCULATING LOOP
- VR- NO-RETURN VALVE
- C- CIRCULATOR
- U- TAPS
- F- COLD WATER MAINS



## 1. INSTALLATION

### 1.1.11. SYSTEM FILLING



#### WARNING

*For system filling use only clean tap water.*



#### WARNING

*If the system is filled by adding ethylene glycol-type chemical agents you have to install on the loading system a hydraulic trip unit in order to separate the heating circuit from the domestic circuit.*

Before powering up the boiler, fill the system as follows:

1. slightly loosen the cap of the circulator jolly valve [1-fig. 1] to release the air from the system;
2. slightly loosen the cap of the jolly valve placed on the top of the condensing block (fig. 3) to release the air from the top of the system;
3. open the feeding tap "R" (fig. 2);
4. release all the air;
5. use pressure gauge "M" (fig. 2) to make sure that the system pressure reaches 1.2 bar, which corresponds to the middle part of the green zone 'ZV' (fig. 4);
6. after performing this operation, make sure that the loading tap "R" (fig. 2) is properly closed.

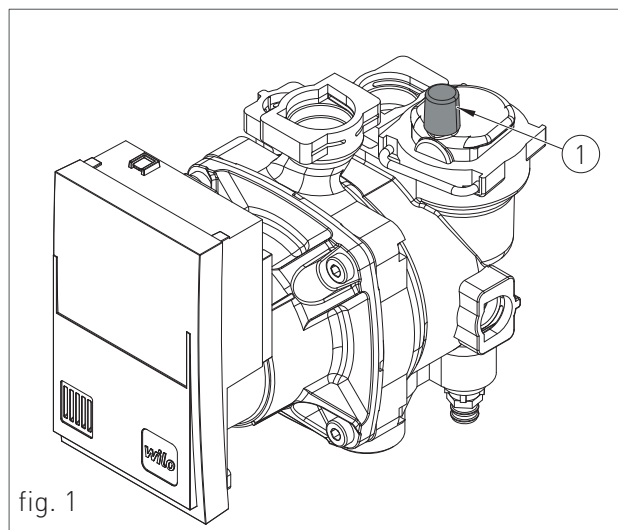

fig. 1

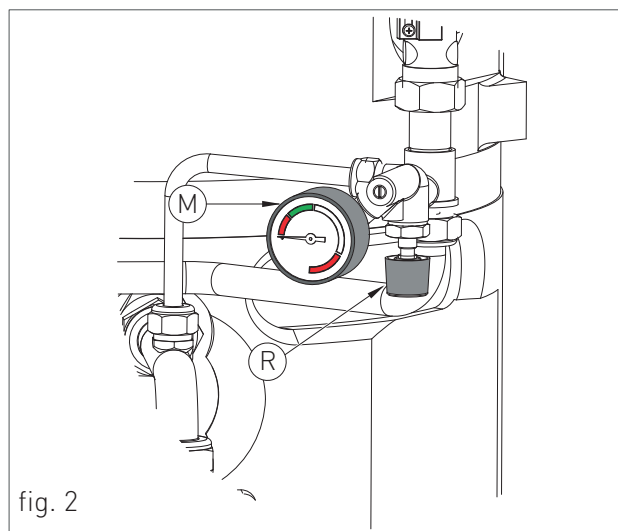

fig. 2

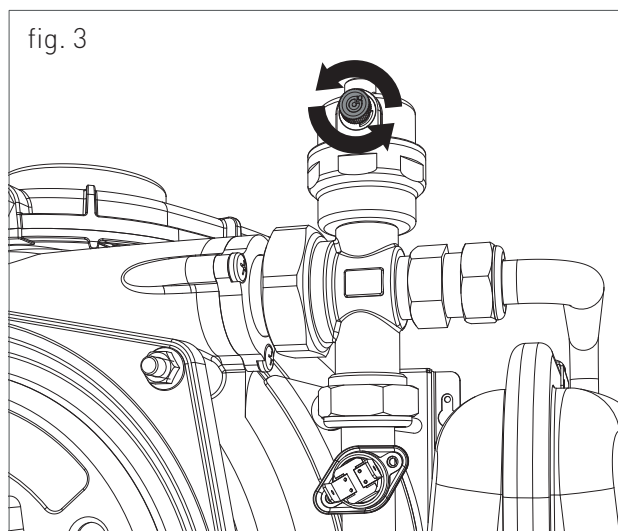
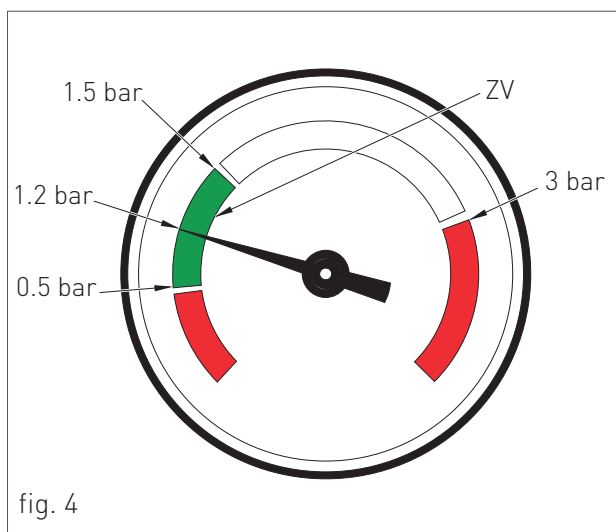

fig. 3



7. open the air relief valves of the radiators and check the air removal process. When the water starts to leak close the radiators air relief valves.
8. if after performing these operations you observe a decrease of the water pressure inside the system, open once again the loading tap "R" until the pressure gauge indicates the value of 1.2 bar, which corresponds to the middle part of the green zone 'ZV' (fig. 4).



### 1.1.12. FILLING THE CONDENSATE COLLECTION SIPHON

Before starting the boiler you have to fill the condensate collection siphon in order to avoid fuel reflux through the siphon.

Fill the condensate collection siphon as follows (see fig. 5):

- › Unscrew the "T" cap from the siphon, fill three quarters of the the siphon with water and screw the "T" cap back in;
- › Connect the dedicated flexible condensate draining tube "P" to a waste disposal system. The condensate can be drained directly in the sewerage system by inserting an easily serviceable siphon.

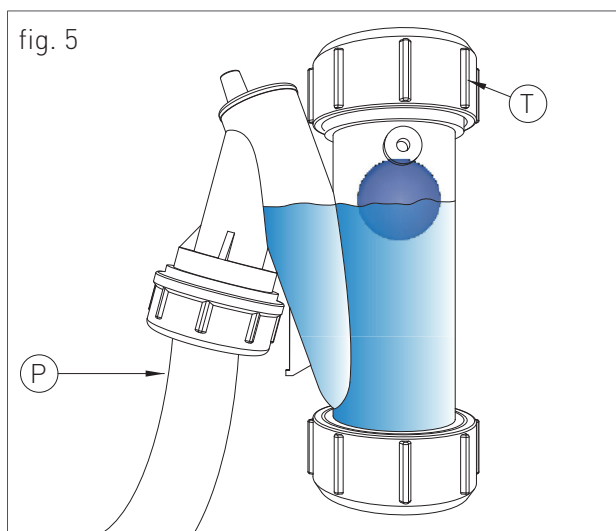



## 1. INSTALLATION

### 1.1.13. ANTI-FREEZE PROTECTION

The boiler is protected against freezing thanks to the electronic board preparation with functions that start the burner and heat the concerned parts when their temperature goes below the minimum pre-set values, protecting the boiler up to an external temperature of -10 °C.

The device starts when the hot water temperature goes below 12°C, automatically starting the burner until the heating flow water temperature reaches the 30°C and, in presence of a return sensor, until the heating return water temperature reaches the 20°C.

The system starts even if on the display appears "OFF", as long as the boiler is connected to the power (230 V) and gas supply.

For long periods of standby, please empty the boiler and the plant.

If the temperature goes below -10° centigrades, please fill the plant with anti-freeze liquid (CLEANPASS FLUIDO AG cod. 98716LA) and insert and electrical resistances kit (cod. 82259LP).

#### DILUTION PERCENTAGE OF CLEANPASS FLUIDO AG

ANTIFREEZE - ETHYLENE GLYCOL (%) VOLUME	TEMPERATURE FREEZING POINT (°C)
20	-7.5
30	-13
35	-18
40	- 22.5
45	-28
50	-33.5
55	-42
60	-50

RECOMMENDED MINIMUM PERCENTAGE OF GLYCOL : 20 %



### 1.1.14. GAS CONNECTION



#### **DANGER**

*In order to connect the gas connector of the boiler to the supply pipe use a stop seal of an appropriate size and material. The use of hemp, teflon tape or similar materials is strictly forbidden.*

#### **BEFORE PERFORMING THE GAS CONNECTION, MAKE SURE THAT:**

- › the gas adduction line complies with the standards and regulations in force;
- › the tubing's section suits the requested capacity and its length;
- › the tubing is equipped with all safety and control devices required by the standards in force;
- › the internal and external seals of the gas infeed plant are checked;
- › the device is suitable for use with the type of gas available by checking the boiler data plate (placed on the inner side of the front casing. If they do not match you must take the necessary measures to adapt the boiler to another type of gas (see chapter GAS TRANSFORMATION);
- › the gas supply pressure falls within the values indicated on the data plate.

### 1.1.15. ELECTRICAL CONNECTION



#### **DANGER**

*The equipment is electrically safe only if it is properly connected to an efficient grounding system, performed in compliance with the safety standards in force. You should check this essential safety requirement. If in doubt, request an accurate check of the electrical system performed by qualified staff, as the manufacturer is not responsible for any damages caused by lack of grounding system.*

- › Make sure that the electrical systems is suitable for the maximum power absorbed by the equipment, value indicated on the data plate.
- › make sure that the cables section is appropriate for the maximum power absorbed by the equipment and that it is however not lower than 1 mm<sup>2</sup>.
- › The equipment works with alternating current of 230 V and 50 Hz. The electrical connection must be performed using an all-pole switch with an opening of at least 3 millimetres between contacts placed upstream from the device.



#### **WARNING**

*Make sure that the phase and neutral cables connection is performed in compliance with the wiring diagram (see chapter POWER SUPPLY).*



#### **WARNING**

*It is strictly forbidden the use of adaptors, multiple plugs and/or extensions for the general power supply of the equipment from the electrical network.*



## 1. INSTALLATION

### 1.1.16. POWER SUPPLY

To power the boiler connect the electrical cables to the terminal inside the control panel as follows:



#### **DANGER**

*Cut off the voltage from the main switch.*

- › remove the boiler's front casing (refer to chapter ACCESSING THE BOILER).
- › loosen the two screws and remove the plate "A" (see fig. 1).
- › after removing the plate, connect the electrical cables to terminal "B" (see fig. 1):
  - the yellow/green cable to the terminal marked with grounding symbol "⏏".
  - the blue cable to the terminal marked with "N".
  - the brown cable to the terminal marked with "L".

After performing these operations, remount plate "A" and the front casing.

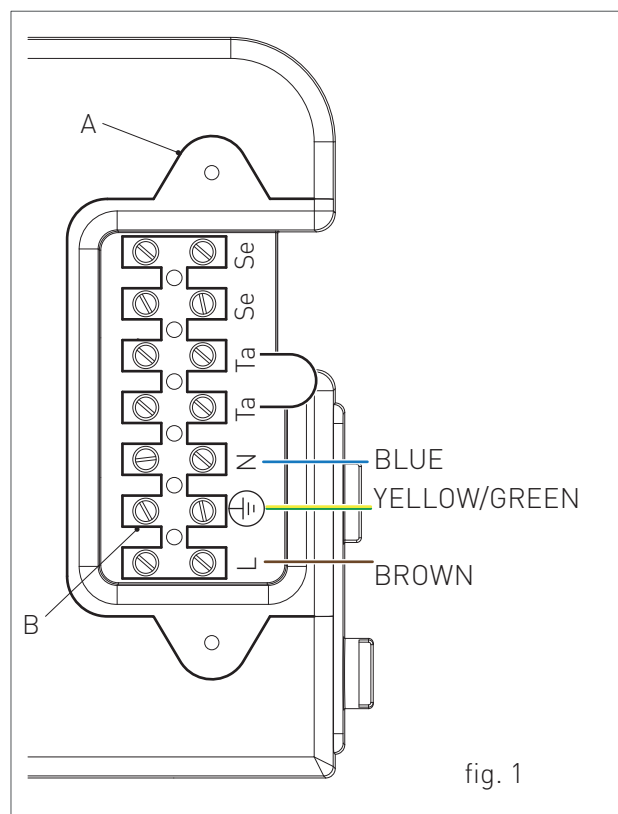

### 1.1.17. OPTIONAL ELECTRICAL CONNECTIONS

To wire the optionals below:

- **(SE) EXTERNAL TEMPERATURE PROBE COD. 73518LA**
- **(TA) ENVIRONMENT THERMOSTAT**
- **(CR) REMOTE CONTROL OPEN THERM COD. 40-00017**

use the terminal placed inside the control panel as follows:



#### DANGER

*Cut off the voltage from the main switch.*

- › remove the front casing of the boiler (see chapter ACCESSING THE BOILER); unscrew the screws and remove plate "A" (see fig. 1).
- › After removing the plate, connect the electrical cables to terminal "B" (see fig. 1):
  - For the external temperature Probe connect the two non-polarized conductors to the Se-Se contacts.
  - For the environment Thermostat or Remote control, first remove the bridge on the Ta-Ta contacts and then connect the two non-polarized conductors to the Ta-Ta contacts.

After performing these operations, remount plate "A" and the front casing.

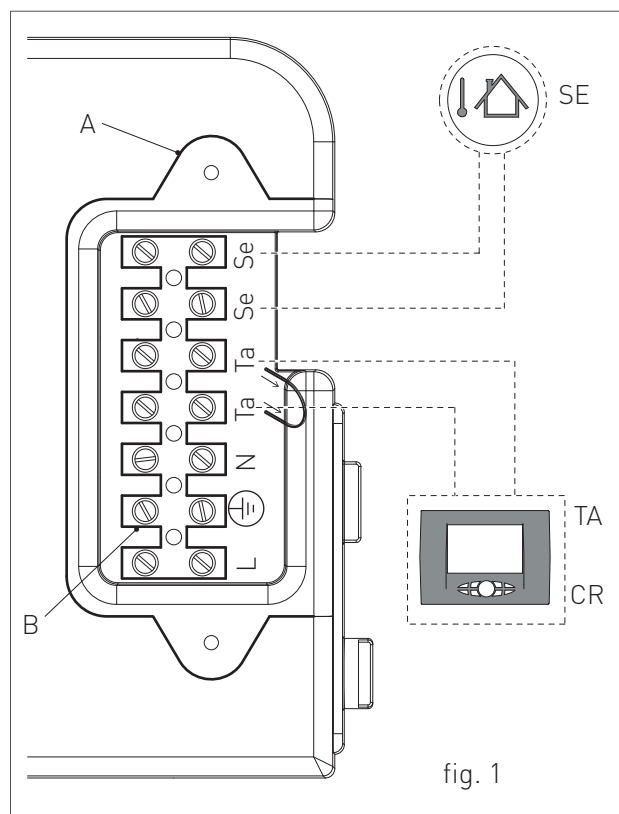

**NB:** In case of simultaneous presence of external probe and remote control, the modulation board only sends the external temperature value to the remote device without using it for modulation.

The communication between board and remote control takes place independently from the boiler's operating mode and after establishing the connection, the used interface on the board is disabled and the display shows the symbol .

To wire the optionals below:

- (TP) DOMESTIC HOT WATER PRE-HEATING DEACTIVATION TIMER
- (CT) TELEPHONE DIALER
- BUS 0-10V
- (SVZ) CONTROL BOARD FOR AREA VALVES CONNECTED TO A REMOTE CONTROL COD. 65-00030

use the electronic board placed inside the control panel as follows:



### DANGER

*Cut off the voltage from the main switch.*

- › remove the boiler's front casing (refer to chapter ACCESSING THE BOILER).
- › remove the crankcase of the control panel (see chapter ACCESSING THE ELECTRONIC BOARD).
- › after removing the crankcase, connect the items below to the electronic board (see fig. 1):

After performing these operations, remount the crankcase and the front casing.

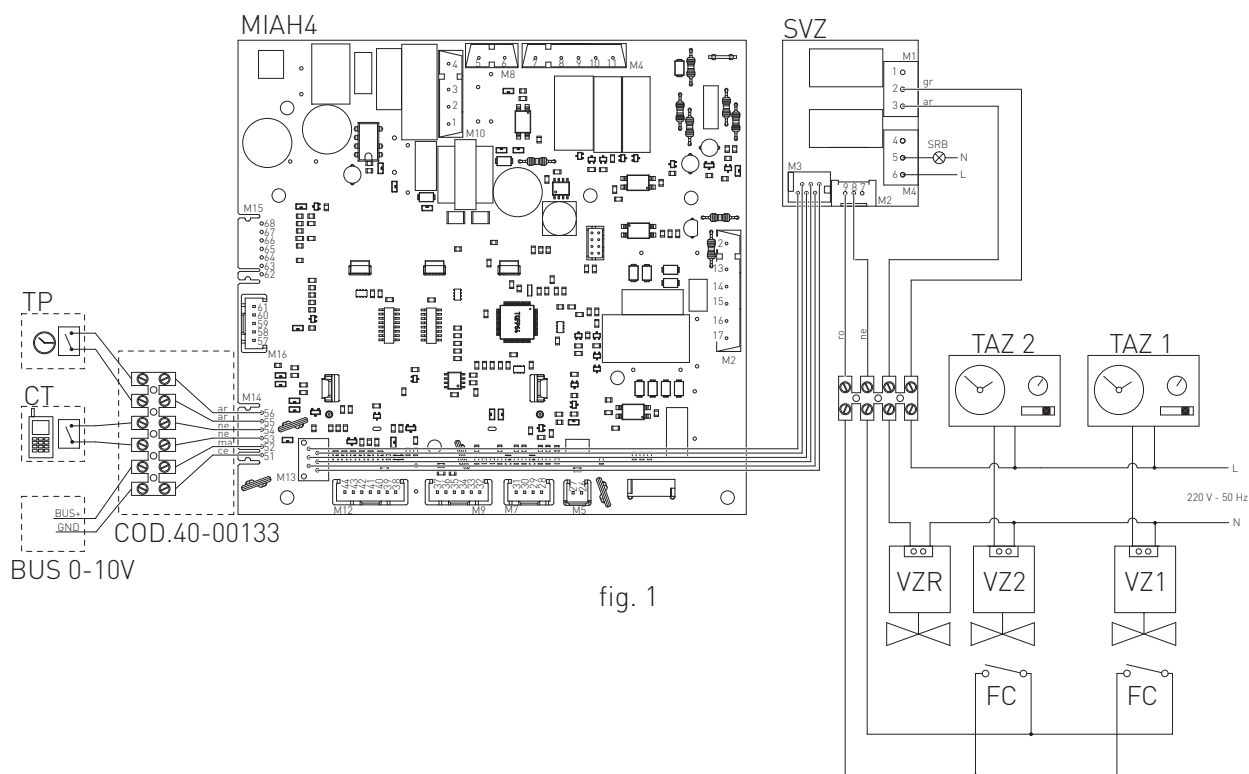

fig. 1

SR:	RETURN PROBE
SRB:	REMOTE LED FOR SIGNALLING BOILER BLOCK
TAZ1:	ENVIRONMENT THERMOSTAT AREA 1
TAZ 2:	ENVIRONMENT THERMOSTAT AREA 2
VZ1:	AREA 1 VALVE
VZ2:	AREA 2 VALVE
VZR:	REMOTE CONTROLLED AREA VALVE

FC:	AREA VALVES LIMIT SWITCH
GR:	GREY
AR:	ORANGE
NE:	BLACK
MA:	BROWN
CE:	LIGHT BLUE
RO:	RED

## 1.1.18. FUME EXHAUST FITTINGS

**WARNING**

*In order to ensure proper operation and efficiency of the device you have to connect the boiler fume exhaust fitting to the fume exhaust duct using appropriate polypropylene flue fittings for condensing boilers. It is recommended to install discharge systems approved by Radiant.*

**WARNING**

*You cannot use traditional flue fittings for the discharge ducts of the condensing boilers, nor vice versa.*

**WARNING**

*For fumes exhaust and condensate collection, please follow the technical standards in force.*

- › For all discharge ducts, with regard to the fumes path, you should provide an uphill slope (outwards) so as to favour the reflux of the condensate towards the combustion chamber, suitably realized to collect and drain acid condensate.
- › For all air suction ducts, with regard to the air path, you should provide an uphill slope (towards the boiler) so as to avoid the protrusion inside the duct of rain water, dust or foreign objects.
- › In case of horizontal co-axial system installation, correctly place the horizontal co-axial terminal suitably realized to respect the slopes inside the fumes duct and to protect the air suction duct from adverse weather conditions.
- › In order to discharge the fumes through a fumes exhaust duct carefully follow the technical standards in force.
- › Make sure that the discharge tube does not protrude inside the fumes exhaust duct, stop before it reaches the inner surface of the latter.

- › The discharge duct must be perpendicular with the opposite internal wall of the chimney or of the fumes exhaust duct (fig. 1).

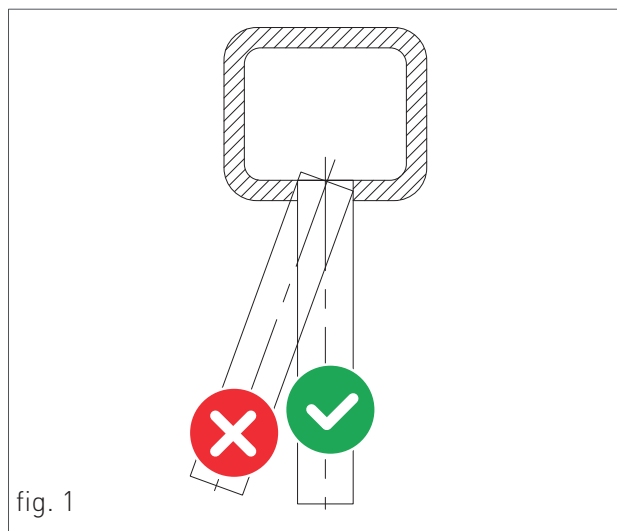

fig. 1



## 1. INSTALLATION

### 1.1.19. INSTALLATION MODES

For this type of boiler are available the following fumes discharge configurations: B23P, B33, C13, C33, C43, C53, C63, C83 e C93 (see Fig. 1).

- › B23P- Indoor suction and outdoor discharge.
- › B33-Indoor suction and fumes exhaust duct discharge.
- › C13- Concentric wall discharge. The tubes can be split but the outputs must be concentric or close enough to each other to undertake similar wind conditions (within 50 cm).
- › C33- Roof concentric discharge. Outputs as for C13.
- › C43-Discharge and suction in common separated fume exhaust ducts, subjected to similar wind conditions.
- › C53-Roof or wall separated discharge and suction, in areas with different pressures. The suction and discharge inlets should not be placed on opposite walls.
- › C63- Discharge and suction systems made with tubes commercialized and certificated separately.
- › C83- Discharge in single or common fume exhaust duct and wall suction system.
- › C93- Discharge through an intubated conduct to a vertical terminal. The technical compartment in which is housed the discharge, also plays the role of combustion air suction duct through the gap that will be formed.

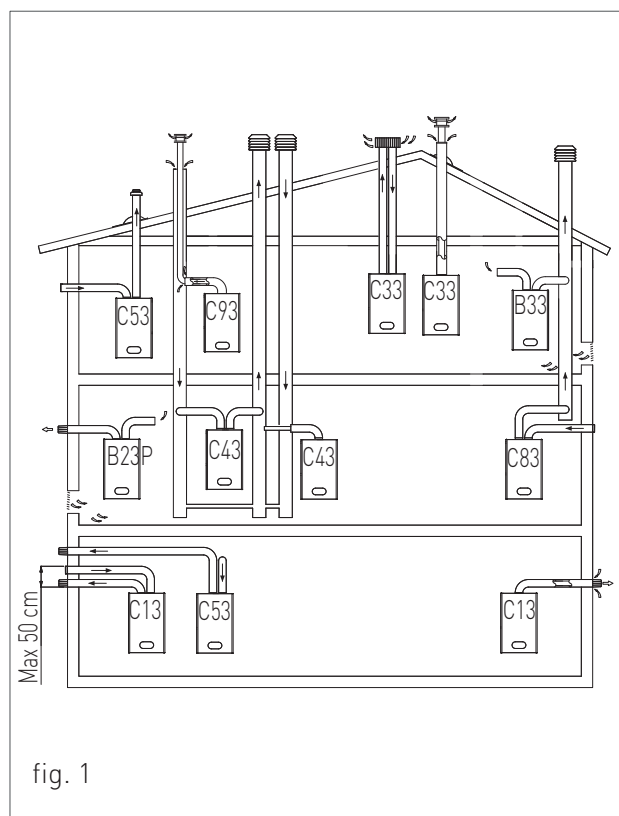

### DISCHARGE OF COMBUSTION PRODUCTS FOR C63-TYPE DEVICES

Each flue fitting has a resistance factor that correspond to a certain tube length (of the same diameter) expressed in metres. These data are provided by the flue fittings distributor. Each boiler has a maximum allowed resistance factor, expressed in Pascal, corresponding to the maximum tubes length with any type of Kit. The maximum allowed strength factor of the ducts installed in this boiler, that should not be exceeded, is specified in the 'TECHNICAL SPECIFICATIONS' section. All this information allow us to perform the necessary calculations to check the possibilities of realizing the most diverse flue fitting configurations.

The ducts must be certified for this specific use and for a temperature greater than 100 °C.





## DISCHARGE OF COMBUSTION PRODUCTS FOR B-TYPE DEVICES

The gas devices, provided with connection for fumes exhaust tube, must be directly connected to efficient chimneys or fume exhaust ducts: only if these are missing you can discharge the combustion products directly through the gas devices.

The connection to the chimney or to the fume exhaust ducts must respect the following requirements:

- Be sealed and realised in materials suitable to resist normal mechanical stress, heat, the action of combustion products and any condensate forming;
- have no more than three changes in direction, including the chimney and/or fume exhaust duct inlet connection, made with internal angles greater than 90°. The changes in direction must be made only by using curved curved elements;
- have the axis of the inlet end perpendicular to the internal wall opposite to the chimney or fume exhaust duct;
- have, along its entire length, a section equal to or greater than that of the connection of the device discharge tube;
- have no shut-off devices (shutters).
- for direct external discharge there must be no more than two changes in direction.

## LOCATIONS VENTING FOR B-TYPE DEVICES

The locations in which are installed gas devices must be vented so as to ensure the amount of air necessary for a regular combustion and for location ventilation. The natural air intake must take place directly through:

- permanent openings on the external walls of the location (windows);
- single or collective, ramified ventilation ducts.

The openings on the external walls of the location must respect the following requirements:

- have a net overall free passage section of at least 6 cm<sup>2</sup> for every kW of heat capacity installed with a minimum of 100 cm<sup>2</sup>;
- they must be realized so as to make sure that the opening inlets are not obstructed (neither indoors nor outdoors);
- they must be protected with grids, metal meshes, etc. so as to keep the useful section mentioned above.
- they must be placed at a height next to the floor level such as to allow proper operation of the combustion products discharge systems; if such position can not be obtained, please increase by at least 50% the section of the vents.



## 1. INSTALLATION

### 1.1.20. TYPES OF FUME EXHAUST SYSTEMS

#### **KIT K - HORIZONTAL CO-AXIAL SYSTEM Ø60/100 INTERNAL POLYPROPYLENE DUCT ADJUSTABLE AT 360°.**

It allows fumes discharge and air intake from external wall.

Suitable only for condensing boilers.

It allows fuel gas discharge and air intake for combustion through co-axial ducts, the external one for air intake, the plastic internal one for fumes discharge.

PLEASE SEE THE MAXIMUM DISCHARGE LENGTH IN THE TABLE IN CHAPTER "TECHNICAL DATA".

The maximum discharge length (or linear reference length) can be calculated summing the length of the linear tube and that equivalent to each additional curve with respect to the first.

Subsequent addition of a curve is similar to adding a linear length of tube according to the indications below:

co-axial curve Ø60/100 at 90° = 1 m

co-axial curve Ø60/100 at 45° = 0.6 m

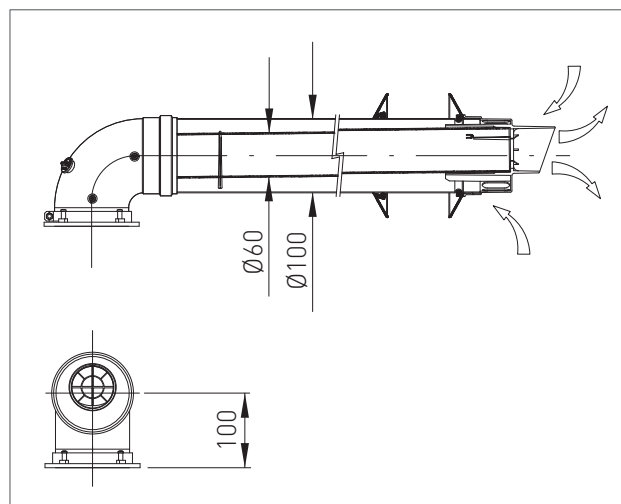

### KIT H - HORIZONTAL SPLIT SYSTEM Ø80/80 MADE OF POLYPROPYLENE, ADJUSTABLE AT 360°.

The two tubes system allows fumes discharge through the fumes exhaust duct and air intake from outside.

Suitable only for condensing boilers.

It allows discharging fuel gas and air suctioning for combustion through two separated ducts.

PLEASE SEE THE MAXIMUM DISCHARGE AND INTAKE LENGTH IN THE TABLE IN CHAPTER "TECHNICAL DATA".

The maximum discharge and intake length (or linear reference length) can be calculated summing the length of the linear tube and that equivalent to each additional curve with respect to the first.

Subsequent addition of a curve is similar to adding a linear length of tube according to the indications below:

curve Ø80 at 90°= 1.5 m

curve Ø80 at 45°= 1.2 m

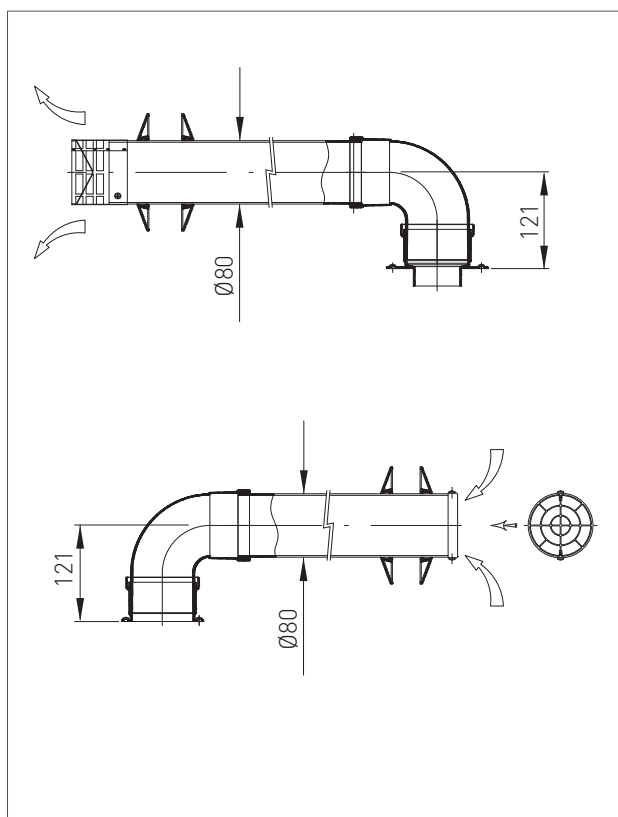



## 1. INSTALLATION

### KIT V - VERTICAL CO-AXIAL SYSTEM Ø60/100 INTERNAL POLYPROPYLENE DUCT.

It allows fumes discharge and air intake directly from roof.

Suitable only for condensing boilers.

It allows fuel gas discharge and air intake for combustion through co-axial ducts, the external one for air intake, the plastic internal one for fumes discharge.

PLEASE SEE THE MAXIMUM DISCHARGE LENGTH IN THE TABLE IN CHAPTER "TECHNICAL DATA".

The maximum discharge length (or linear reference length) can be calculated summing the length of the linear tube and that equivalent to each additional curve with respect to the first.

Subsequent addition of a curve is similar to adding a linear length of tube according to the indications below:

curve Ø60/100 at 90° = 1 m

curve Ø60/100 at 45° = 0.6 m

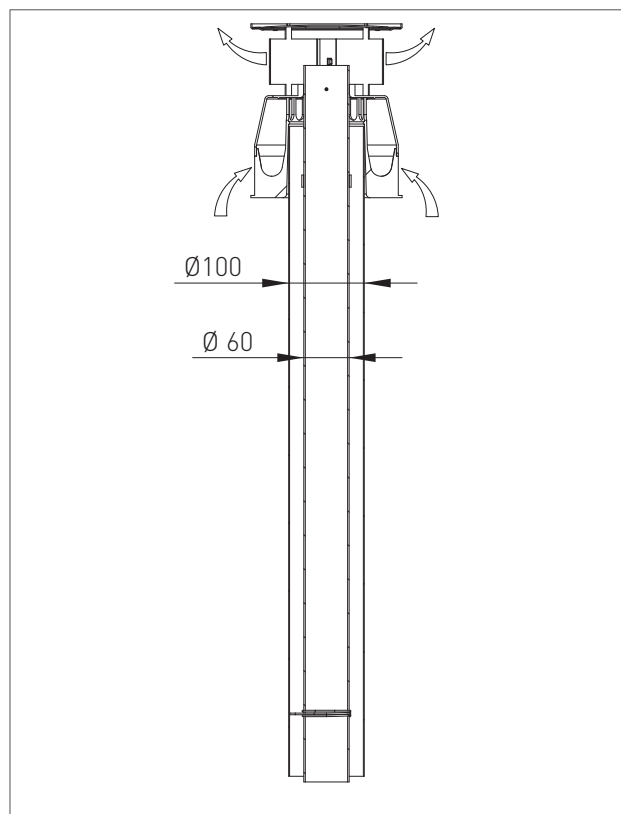



## 2. SUPPORT CENTRE SECTION

All operations described below relative to first start-up, maintenance and replacement should be performed only by qualified personnel and authorized by RADIANT BRUCIATORI S.p.A.



### 2.1. FIRST START-UP

#### 2.1.1. PRELIMINARY OPERATIONS FOR FIRST START-UP

The first start-up operations consist in checking the correct installation, adjustment and operation of the device. Proceed as follows:

- › check the inner system sealing in accordance with the indications provided by standard and regulations in forced;
- › check if the gas used is suitable for the boiler;
- › check if the gas capacity and relative pressures comply with those on the plate;
- › check the intervention of the safety device in case of lack of gas;
- › make sure that the device supply voltage corresponds with that on the plate (230 V – 50 Hz) and that the wiring is correct;
- › make sure that the grounding system works properly;
- › make sure that the combustion air adduction and fumes and condensate discharge take place properly in compliance with the Local and National Laws and Standards in force;
- › make sure that the fumes discharge tube and its connection to the fume exhaust duct comply with the requirements of the Local and National Laws and Standards;
- › make sure that the heating system gate valves are open;
- › make sure that there is no intake of gaseous products within the system;
- › make sure that there are no flammable liquids or materials near the device;
- › open the boiler gas tap and make sure that there are no gas leaks upstream from the device (the burner gas connection must be checked while the machine is running);
- › in case of new installation of the gas supply network, the air inside the tubes may block the device at its first start-up. You might have to repeat the start-up procedure to purge all the air inside the tube.



## 2.1.2. BOILER COMMISSIONING



### WARNING

*Make sure that the system is correctly filled.*

Proceed with boiler commissioning as follows:

Make sure the gas feed valve is switched off

- › Power the boiler.

THE START-UP SYSTEM WILL AUTOMATICALLY ACTIVATE THE SYSTEM AIR RELIEF CYCLE FUNCTION DISPLAYED ON SCREEN WITH CODE "F33" (ONLY AT FIRST START-UP WILL LAST FOR 5 MINUTES\*). When function "F33" is active, the pump is enabled and the burner start-up request is disabled. The boiler can work normally only after completing the operation.

- › Make sure the circulating pump is unblocked.
- › If it should be blocked, wait for the circulating pump to activate the automatic reset (lasting 3 min.)
- › If the circulating pump should be still blocked, activate the circulating pump automatic reset again (further 3 minutes), and switch off the power supply and switch it on again.
- › Open the gas tap.
- › Use the button  to select the desired operation mode. If the symbol is displayed fixed, it means that the function has been activated.
- › The burner will start as soon as the thermostat contact is closed ;
- › If the flame is missing, the board will repeat the start-up operations after post-ventilation (20 seconds).
- › You might have to repeat the start-up operation several times to release all the air inside the gas

tube. Before repeating the operation, wait at least 5 seconds from the last start-up attempt and unlock the boiler from "E01" error code by pressing the Reset  key.

(\*) The boiler performs the system venting cycle function (5 minutes) only during the first starting. After every water pressure reset the boiler will automatically perform a reduced system venting cycle (2 minutes). During this function the display shows F33 code. The correct boiler operation will be allowed only after this operation has been completed.





 The CO<sub>2</sub> value should be checked with the casing assembled, while the gas valve should be adjusted with the casing open.



To check and calibrate the CO<sub>2</sub> value to minimum and maximum heating power proceed as follows:

FOR MINIMUM HEATING POWER

- › Activate the chimney sweeper function (F07) by keeping pressed the key 'R' for 7 seconds (the maximum time of this function is 15 minutes).
- › Insert the fumes analyser probe in the suitable 'PF' fumes inlet (fig. 1), then make sure that the CO<sub>2</sub> value complies with the requirements indicated in chapter "Technical data", otherwise unscrew the protection screw 'A' (fig. 2) and adjust using a 4 Allen wrench the screw '2' (fig. 2) of the Off-Set adjuster. To increase the CO<sub>2</sub> value, turn the screw clockwise and vice-versa if you want to decrease it. Once completed the adjustment, tighten the protection screw 'A' (fig. 2) on the Off-Set adjuster.

FOR MAXIMUM HEATING POWER

- › Press the key ‘’ of the heating temperature setting , to adjust the maximum heating power.
- › Make sure that the CO<sub>2</sub> value complies with the indications in “Technical data”, otherwise adjust using screw ‘1’ (fig. 2) of the gas flow adjuster. To increase the CO<sub>2</sub> value, turn the screw anti-clockwise and vice-versa if you want to decrease it.
- › After each adjustment variation on screw ‘1’ (fig. 2) of the gas flow adjuster you have to wait for the boiler to stabilize itself to the set value (about 30 seconds).

- › Press the key  of the heating temperature setting  and make sure that the CO<sub>2</sub> value did not change to minimum, if changed repeat the calibration described in the previous paragraph.
- › Deactivate the chimney sweeper function by selecting the OFF mode by using the key .









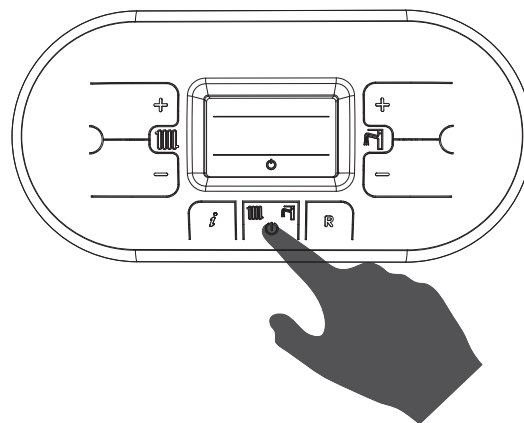

## 2.1.4. ACCESSING AND PROGRAMMING THE PARAMETERS

To access the parameters menu and adjust their values, follow the procedure below:

1. Press the button  to select the OFF mode displayed using the symbol .



2. Hold at the same time the keys  and  until on the display appears the symbol  with the message 'P00', and release the keys  and .

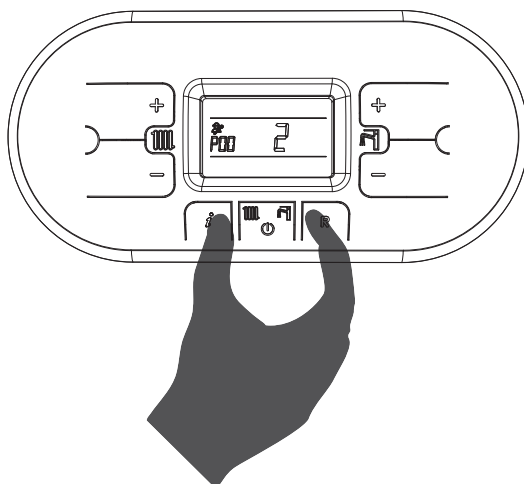

3. Use the keys  and  of the heating circuit  to select the parameter to be edited.

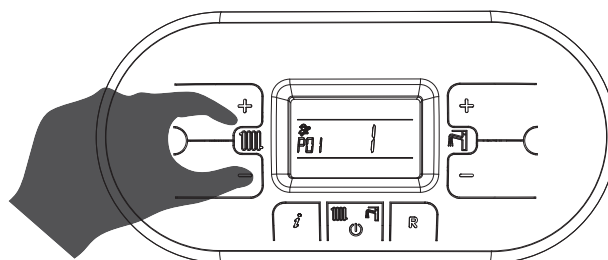

4. Use the keys '+' and '-' of the domestic circuit  to change the value of the parameter.

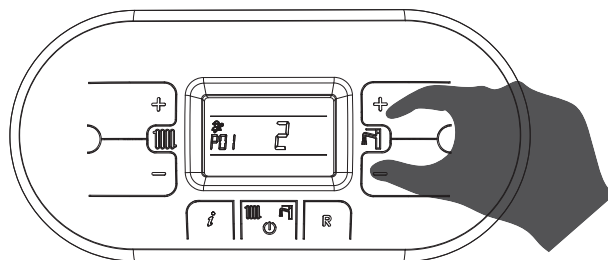

5. Press the key  to confirm the action and wait for the display to stop blinking, indication of the fact that the adjustment was implemented.

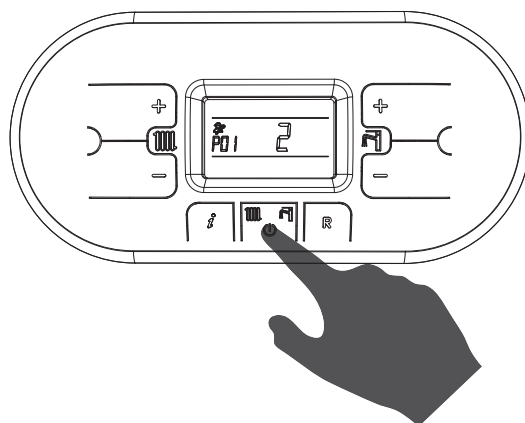

6. To exit the parameters menu, hold at the same time the keys 'i' and 'R' and wait for the symbol  to appear on the display.

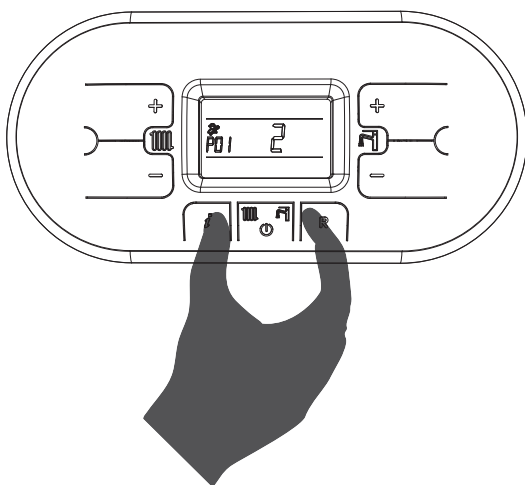



## 2.1.5. DIGITECH CS PARAMETERS TABLE

PARAMETER	DESCRIPTION	RANGE	FUNCTION
P00	<b>BOILER MODEL SELECTION</b>	0 - 10	0 = 13 KW
			1 = 18 KW (HEAT.) / 24 KW (DOMESTIC)
			2 = 25 KW
			3 = 28 KW
			4 = 34 KW
			5 = 55 KW
			6 = 100 KW
			7 = R1K 18_24-R2K 24-R2KA 24 (IN ALL VERSIONS)
			8 = R1K 25_28-R2K 28-R2KA 28 (IN ALL VERSIONS)
			9 = R1K 34-R2K 34-R2KA 34 (IN ALL VERSIONS)
			10 = R1K 50
P01	<b>BOILER TYPE SELECTION</b>	0 - 5	0 = INSTANTANEOUS R2K
			1 = INSTANTANEOUS RKR
			2 = ACCUMULATION
			3 = ACCUMULATION COMFORT
			4 = INSTANTANEOUS COMFORT - FAST H2O
			5 = HEATING ONLY



## 2. FIRST START-UP

PARAMETER	DESCRIPTION	RANGE	FUNCTION
P02	<b>GAS TYPE SELECTION</b> <b>ATTENTION:</b> READ THE INSTRUCTION IN CHAPTER 'GAS TRANSFORMATION' BEFORE CHANGING THIS PARAMETER.	0 - 1	0 = METHANE 1 = LPG
P03	<b>SETTING THE HEATING TEMPERATURE</b> IN CASE THE BOILER IS INSTALLED AS PART OF A LOW TEMPERATURE CIRCUIT, PLEASE INSTALL A SAFETY THERMOSTAT ON THE HEATING FLOW, WHICH CAN STOP THE BOILER ACTIVITY IN CASE OF HIGH HEATING FLOW TEMPERATURE. THE COMPANY ASSUMES NO LIABILITY FOR DAMAGE CAUSED TO PERSONS OR FOR FAILURE TO COMPLY WITH THESE INSTRUCTIONS.	0 - 1	0 = STANDARD (30-80 °C) (SET BY DEFAULT) 1 = REDUCED (25-45 °C) FOR FLOOR SYSTEMS
P04	<b>HEATING RUN-UP</b> THROUGH THIS PARAMETER YOU CAN SET THE TIME, DURING START-UP PHASE, NECESSARY FOR THE BOILER TO REACH THE MAXIMUM SET POWER (ON THE HEATING SIDE).	0 - 4	0 = (DISABLED) 1 = 50 SECONDS (SET BY DEFAULT) 2 = 100 SECONDS 3 = 200 SECONDS 4 = 400 SECONDS
P05	<b>ANTI-WATER HAMMER SELECTION</b> ONCE THIS FUNCTION IS ENABLED, THE DHW CONTACT WILL BE DELAYED FOR A TIME EQUAL TO THE SET VALUE.	0 - 20	0 = DISABLED 1 - 20 = THE VALUE IS EXPRESSED IN SECONDS
P06	<b>DOMESTIC CIRCUIT PRESERVATION FUNCTION</b> <b>(ONLY FOR INSTANTANEOUS BOILERS)</b> THROUGH THIS PARAMETER YOU CAN PRESERVE THE CIRCULATOR THE DIVERTER VALVE IN DOMESTIC POSITION FOR A PERIOD OF TIME EQUAL TO THE POST-CIRCULATION (SEE PARAMETER P09), SO AS TO MAINTAIN THE SECONDARY EXCHANGER HOT.	0 - 1	0 = DISABLED (SET BY DEFAULT) 1 = ENABLED
P07	<b>HEATING TIMING</b> THROUGH THIS PARAMETER YOU CAN SET THE MINIMUM TIME FOR WHICH THE BURNER WILL BE TURNED OFF ONCE THE HEATING TEMPERATURE REACHED THE USER SET TEMPERATURE.	0 - 90	VALUE EXPRESSED IN MULTIPLES OF 5 SECONDS (PRE-SET AT 36 X 5 = 180 SECONDS)



PARAMETER	DESCRIPTION	RANGE	FUNCTION
<b>P08</b>	<b>POST-CIRCULATION HEATING TIMING</b> THROUGH THIS PARAMETER YOU CAN SET THE PUMP DURATION OF OPERATION DURING HEATING CYCLE, AFTER THE MAIN BURNER TURNS OFF DUE TO THE ENVIRONMENT THERMOSTAT.	0 - 90	VALUE EXPRESSED IN MULTIPLES OF 5 SECONDS (PRE-SET AT $36 \times 5 = 180$ SECONDS)
<b>P09</b>	<b>POST-CIRCULATION DOMESTIC / BOILER TIMING</b> THROUGH THIS PARAMETER YOU CAN SET THE PUMP OPERATION DURATION ON THE DOMESTIC CIRCUIT, AFTER THE TAP IS CLOSED.	0 - 90	VALUE EXPRESSED IN MULTIPLES OF 5 SECONDS (PRE-SET AT $24 \times 5 = 120$ SECONDS)
<b>P10</b>	<b>DOMESTIC FAN MINIMUM SPEED ADJUSTMENT</b> THROUGH THIS PARAMETER YOU CAN SET THE FAN MINIMUM SPEED IN DOMESTIC PHASE, THAT CORRESPONDS TO THE MINIMUM BURNER POWER DURING A REQUEST TO OPERATE IN DOMESTIC MODE. THE VALUE IS PRE-SET BASED ON THE SET POWER (SEE PARAMETER P00) AND ON THE GAS TYPE (SEE PARAMETER P02)	45 - VALUE SET FOR PARAMETER P11	THE VALUE IS EXPRESSED IN HERTZ (1HZ = 30 RPM)
<b>P11</b>	<b>DOMESTIC FAN MAXIMUM SPEED ADJUSTMENT</b> THROUGH THIS PARAMETER YOU CAN SET THE FAN MAXIMUM SPEED IN DOMESTIC PHASE, THAT CORRESPONDS TO THE MAXIMUM BURNER POWER DURING A REQUEST TO OPERATE IN DOMESTIC MODE. THE VALUE IS PRE-SET BASED ON THE SET POWER (SEE PARAMETER P00) AND ON THE GAS TYPE (SEE PARAMETER P02)	VALUE SET FOR PARAMETER P10 - 203	THE VALUE IS EXPRESSED IN HERTZ (1HZ = 30 RPM)
<b>P12</b>	<b>HEATING FAN MINIMUM SPEED ADJUSTMENT</b> THROUGH THIS PARAMETER YOU CAN SET THE FAN MINIMUM SPEED IN HEATING PHASE, THAT CORRESPONDS TO THE MINIMUM BURNER POWER DURING A REQUEST TO OPERATE IN HEATING MODE. [SEE CHAPTER 'HEAT CAPACITY DIAGRAM (KW) - ELECTRIC FAN FREQUENCY (HZ)']. THE VALUE IS PRE-SET BASED ON THE SET POWER (SEE PARAMETER P00) AND ON THE GAS TYPE (SEE PARAMETER P02)	45 - VALUE SET FOR PARAMETER P13	THE VALUE IS EXPRESSED IN HERTZ (1HZ = 30 RPM)



## 2. FIRST START-UP

PARAMETER	DESCRIPTION	RANGE	FUNCTION
P13	<b>HEATING FAN MAXIMUM SPEED ADJUSTMENT</b> THROUGH THIS PARAMETER YOU CAN SET THE FAN MAXIMUM SPEED IN HEATING PHASE, THAT CORRESPONDS TO THE MAXIMUM BURNER POWER DURING A REQUEST TO OPERATE IN HEATING MODE [SEE CHAPTER 'HEAT CAPACITY DIAGRAM (KW) -ELECTRIC FAN FREQUENCY (HZ)']. THE VALUE IS PRE-SET BASED ON THE SET POWER (SEE PARAMETER P00) AND ON THE GAS TYPE (SEE PARAMETER P02)	VALUE SET FOR PARAMETER P12 - 203	THE VALUE IS EXPRESSED IN HERTZ (1HZ = 30 RPM)
P14	<b>STARTING STEP ADJUSTMENT</b> THROUGH THIS PARAMETER YOU CAN SET THE FAN SPEED DURING START-UP THE VALUE IS PRE-SET BASED ON THE SET POWER (SEE PARAMETER P00) AND ON THE GAS TYPE (SEE PARAMETER P02)	VALUE SET FOR PARAMETER P10 - 203	THE VALUE IS EXPRESSED IN HERTZ (1HZ = 30 RPM)
P15	<b>ANTI-LEGIONELLA FUNCTION (FOR STORAGE BOILERS ONLY)</b> THROUGH THIS PARAMETER YOU CAN ACTIVATE/DEACTIVATE THE "ANTILEGIONELLA" HEAT TREATMENT OF THE STORAGE TANK. EVERY 7 DAYS THE WATER TEMPERATURE INSIDE THE STORAGE IS HEATED BEYOND 60 °C THUS GENERATING A BURNING HAZARD. KEEP UNDER CONTROL SUCH DOMESTIC HOT WATER TREATMENT (AND INFORM THE USERS) TO AVOID UNFORSEEABLE DAMAGES TO PERSONS, ANIMALS AND PROPERTY. A THERMOSTATIC VALVE SHOULD BE INSTALLED AT THE DOMESTIC HOT WATER OUTLET TO AVOID ANY BURNS.	0 - 1	0 = DISABLED  1 = ENABLED (PRE-SET BY DEFAULT ON STORAGE BOILERS ONLY)



PARAMETER	DESCRIPTION	RANGE	FUNCTION
P16	<b>CLIMATE COMPENSATION CURVE</b> <b>(ONLY WITH EXTERNAL PROBE CONNECTED)</b>  YOU CAN CONNECT AN EXTERNAL TEMPERATURE PROBE (SEE CHAPTER 'ELECTRICAL CONNECTIONS') THAT AUTOMATICALLY CHANGES THE DELIVERY TEMPERATURE BASED ON THE EXTERNAL MEASURED TEMPERATURE. THE NATURE OF THE CORRECTION DEPENDS ON THE THERMO-ADJUSTMENT VALUE KD SET (SEE CHART).  THE SELECTION OF THE CURVE IS DETERMINED BY THE MAXIMUM DELIVERY TEMPERATURE $T_m$ AND THE MINIMUM EXTERNAL TEMPERATURE $T_e$ TAKING INTO ACCOUNT THE HOUSE INSULATION DEGREE.  THE VALUES OF THE DELIVERY TEMPERATURES $T_m$ , REFER TO STANDARD SYSTEMS 30-80 °C OR FLOOR SYSTEMS 25-45 °C. THE SYSTEM TYPE CAN BE SET FROM PARAMETER P03.	0 - 30	(SET BY DEFAULT AT 15) THE NUMBERING OF THE VALUE CORRESPONDS TO 'KD' CURVES ON THE CHART (SEE CHART BELOW).

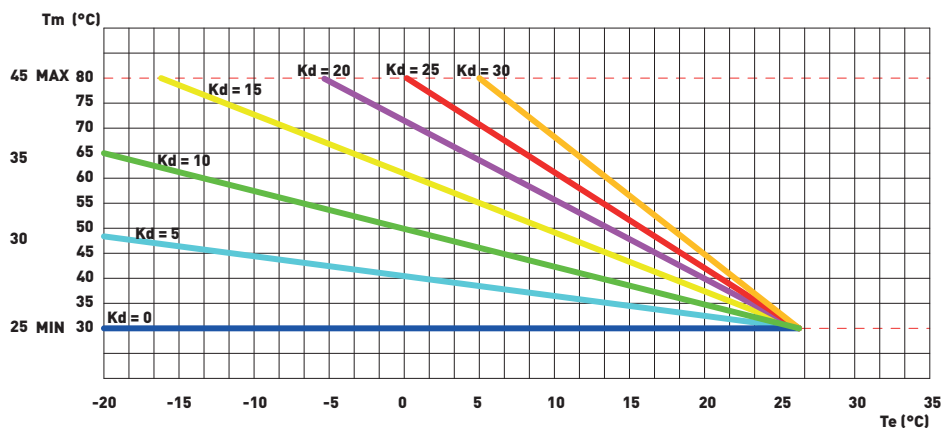

P17	<b>DISABLEMENT OF DOMESTIC HOT WATER LINE BY MEANS OF SWITCH (ONLY FOR FAST BOILERS)</b>  BY ENABLING THIS PARAMETER IN THE PRESENCE OF A CONNECTION (FOR EXAMPLE A BOILER CLOCK OR A TEMPERATURE THERMOSTAT) ON BOILER CLOCK SWITCH ON THE BOARD, THE REQUEST FOR BURNER IGNITION ON THE DOMESTIC HOT WATER LINE WILL BE DISABLED UPON BOILER CLOCK SWITCH CLOSURE.  <b>EXAMPLE 1:</b> WITH THE BOILER CLOCK SWITCH OPEN, UPON THE REQUEST FOR DOMESTIC HOT WATER, THE FLOW SWITCH AND THE BOILER WILL TURN ON.  <b>EXAMPLE 2:</b> WITH THE BOILER CLOCK SWITCH CLOSE, UPON THE REQUEST FOR DOMESTIC HOT WATER, THE FLOW SWITCH AND THE BOILER WILL NOT TURN ON.	0 - 1	0 = DISABLED (SET BY DEFAULT)  1 = ENABLED
-----	---	-------	---



## 2. FIRST START-UP

PARAMETER	DESCRIPTION	RANGE	FUNCTION
P18	<b>ENABLING BUS INDUSTRIAL PILOTING 0 -10V</b> THROUGH THIS PARAMETER YOU CAN ENABLE OR DISABLE THE BUS INDUSTRIAL INPUT 0-10 V TO SET THROUGH EXTERNAL BUS THE BURNER POWER OR THE DELIVERY TEMPERATURE.	0 - 2	0 = DISABLED (SET BY DEFAULT)  1 = TEMPERATURE CONTROL MODE  2 = POWER CONTROL MODE
P19	<b>MINIMUM HEATING SETPOINT</b> THROUGH THIS PARAMETER YOU CAN SET THE USER-ADJUSTABLE MINIMUM HEATING TEMPERATURE.	20 - 40	THE VALUE IS EXPRESSED IN °C
P20	<b>MAXIMUM HEATING SETPOINT</b> THROUGH THIS PARAMETER YOU CAN SET THE USER-ADJUSTABLE MAXIMUM HEATING TEMPERATURE.	40 - 90	THE VALUE IS EXPRESSED IN °C
P21	<b>MAXIMUM DOMESTIC SETPOINT</b> THROUGH THIS PARAMETER YOU CAN SET THE USER-ADJUSTABLE MAXIMUM DOMESTIC TEMPERATURE.	45 - 75	THE VALUE IS EXPRESSED IN °C
P22	<b>SET POINT <math>\Delta</math>T DELIVERY-RETURN</b> <b>(ONLY WITH MODULATING PUMP AND RETURN PROBE CONNECTED)</b> THROUGH THIS PARAMETER YOU CAN SET THE TEMPERATURE DIFFERENCE BETWEEN DELIVERY AND RETURN.	0  10 - 40	0 = DISABLED  THE VALUE IS EXPRESSED IN °C
P23	<b>MODULATING PUMP MINIMUM SPEED</b> <b>(ONLY WITH MODULATING PUMP AND RETURN PROBE CONNECTED)</b> THROUGH THIS PARAMETER YOU CAN SET THE MINIMUM SPEED VALUE OF THE MODULATING PUMP DURING A REQUEST TO OPERATE IN HEATING MODE.	50 - 70	THE VALUE IS EXPRESSED IN PERCENTAGE
P24	<b>MODULATING PUMP MAXIMUM SPEED</b> <b>(ONLY WITH MODULATING PUMP AND RETURN PROBE CONNECTED)</b> THROUGH THIS PARAMETER YOU CAN SET THE MAXIMUM SPEED VALUE OF THE MODULATING PUMP DURING A REQUEST TO OPERATE IN HEATING MODE.	70 - 100	THE VALUE IS EXPRESSED IN PERCENTAGE





PARAMETER	DESCRIPTION	RANGE	FUNCTION
P25	<b>D.H.W STORAGE TANK TEMPERATURE SETPOINT</b> <b>(FOR STORAGE BOILERS ONLY)</b>  THROUGH THIS PARAMETER YOU CAN SET THE PRIORITY STARTING VALUE OF THE STORAGE TANK, COMPARED TO THE USER ADJUSTABLE D.H.W SETPOINT.	3 - 9	THE VALUE IS EXPRESSED IN °C (PRE-SET AT 9°C)

### 2.1.6. ELECTRIC FAN FREQUENCY/HEAT CAPACITY DIAGRAM

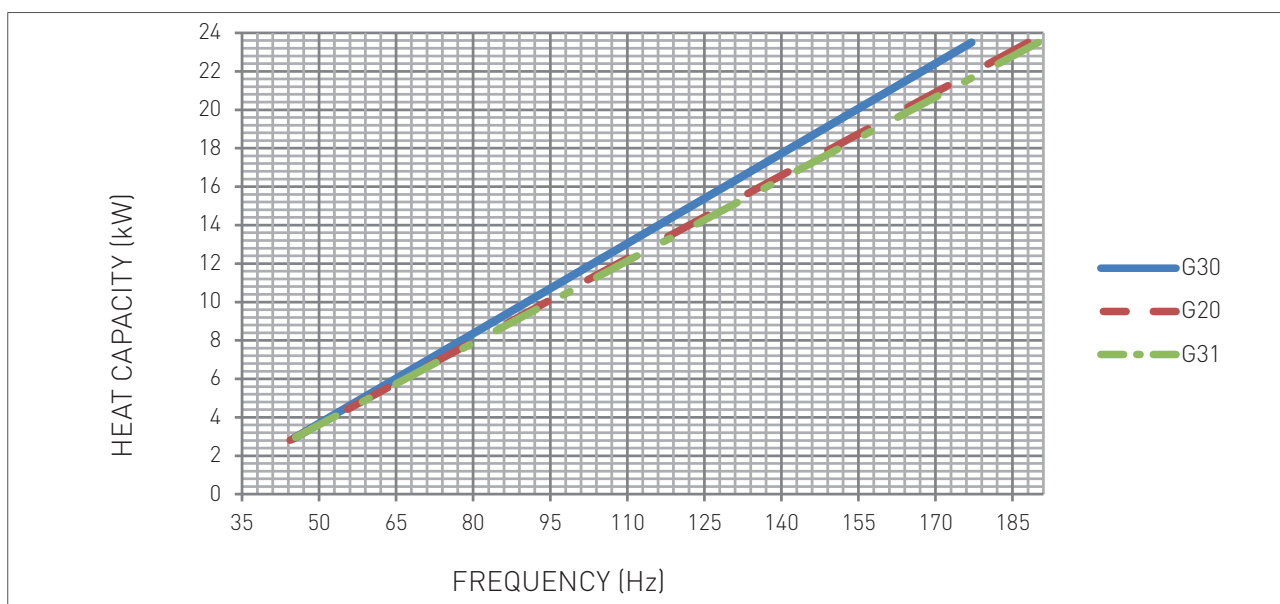

GAS TYPE		MINIMUM FREQUENCY	MAXIMUM FREQUENCY
G20	Hz	45	188
G30	Hz	45	177
G31	Hz	45	190



## 2.2. MAINTENANCE

### 2.2.7. GENERAL MAINTENANCE WARNINGS



#### DANGER

*Before each components cleaning or replacement operation, ALWAYS cut off the POWER, WATER and GAS supply of the boiler.*



#### WARNING

*To ensure greater life span and proper operation of the device, during the maintenance operations use only original spare parts.*



#### ATTENTION

*To ensure the efficiency and safety of the device, the maintenance operations must be realized on an annual basis. The operations described below, are essential to the validity of the standard RADIANT warranty and must be performed by professionally qualified personnel in accordance with current legislation and authorized by RADIANT.*

Please perform the following operations once a year:

- › check the integrity and the position of the sealed chamber sealing gasket;
- › check the primary exchanger, if necessary, clean it;
- › check the operation of the gas light up and safety systems. If necessary, remove and clean the flame detection and light up electrodes from incrustations paying attention to respect the distances with respect to the burner;
- › check the heating circuit safety systems: limit temperature safety thermostat; limit pressure safety;
- › check the pre-load pressure of the expansion vessel;
- › make sure that the permanent ventilation outlets are present, correctly sized and functioning, based on the installed devices. Respect the requirements provided by Local and National legislation;
- › periodically check the integrity of the fume exhaustion system for safety and proper operation;
- › check that the wiring is performed in compliance with the requirements in the boiler instruction manual;
- › check the wiring inside the control panel;
- › check the flow and temperature of domestic hot water;
- › check the proper operation of the condensate draining system, including the devices outside the boiler such as condensate collection devices installed along the path of the fume exhaust duct or neutralization devices for acid condensate.
- › Check that the system's water PH is between 6.5 and 8.5;
- › check the sealing of the gas components, and replace if necessary the gaskets;
- › check the sealing of the water components, and replace if necessary the gaskets;
- › visually check the flame and the condition of the combustion chamber;
- › if necessary make sure that the combustion is suitably adjusted and if required proceed as indicated in section "CO2 VALUE CHECK AND CALIBRATION";
- › remove and clean the burner from oxidation;



## 2. MAINTENANCE

---

- › check that the liquid flow is not obstructed and that there are no combustion gas refluxes inside the internal system.



## 2.2.8. TECHNICAL DATA

Model		R2KA 24 /40
CE certification	no.	0476CQ0134
Gas category		II2H3B/P
Discharge type	type	B23p-B33-C13-C33-C43-C53-C63-C83-C93
Energy efficiency 92/42 CEE	no. stars	4
Energy efficiency EN13203-1	no. stars	3
Maximum nominal heat capacity in heating circuit	kW	23,5
Maximum nominal heat capacity in domestic circuit	kW	23,5
Minimum nominal heat capacity in heating circuit	kW	2,9
Minimum nominal heat capacity in domestic circuit	kW	2,9
Useful thermal power - 60/80°C	kW	22,7
Minimum useful thermal power - 60/80°C	kW	-
Useful thermal power - 30/50°C	kW	24,79
Performance at 100% Pn - 60/80°C	%	96,6
Performance at 30% Pn - return 47°C	%	-
Performance at 30% Pn - return 30°C	%	107
Performance at 100% Pn - 30/50°C	%	105,5
Maximum combustion Performance	%	97,4
Fumes temperature at nominal heat capacity	°C	80,26
Fumes temperature at minimum heat capacity	°C	65,7
CO <sub>2</sub> at nominal heat capacity - G20	%	9,3 - 9,1
CO <sub>2</sub> at minimum heat capacity - G20	%	9 - 8,8
CO <sub>2</sub> at nominal heat capacity - G30	%	11,4 - 11,2
CO <sub>2</sub> at minimum heat capacity - G30	%	10,9 - 10,7
CO <sub>2</sub> at nominal heat capacity - G31	%	10,5 - 10,3
CO <sub>2</sub> at minimum heat capacity - G31	%	10,2 - 10
CO at nominal heat capacity	ppm	67
Fumes mass at nominal heat capacity	g/s	10,38
Fumes mass at minimum heat capacity	g/s	1,26
NO <sub>x</sub> class	class	6
Weighted Nox [0% O <sub>2</sub> ] mg/kWh	mg/kWh	35
<b>Heating circuit</b>		
Adjustable heating temperature	°C	30-80 / 25-45
Maximum operating temperature for heating circuit	°C	80
Maximum operating pressure for heating circuit	bar	3
Minimum operating pressure for heating circuit	bar	0,3
Capacity of the system expansion vessel	litres	10
<b>Domestic circuit</b>		
Adjustable domestic temperature	°C	35-60
Maximum pressure for domestic circuit	bar	8
Minimum pressure for domestic circuit	bar	0,5
Storage cylinder capacity	litres	40



## 2. MAINTENANCE

Continuous hot water supply -  $\Delta T$  30° - mixed water - 1 hour litres 726

Continuous hot water supply -  $\Delta T$  30° - mixed water - for the first 10 minutes litres 160

### Dimensional characteristics

Width mm 600

Depth mm 655

Height mm 845

Gross weight Kg 88

### Water connections

Flow Ø 3/4"

Cold water Ø 3/4"

Hot water Ø 3/4"

Gas Ø 3/4"

Return Ø 3/4"

D.H.W. circulating loop connection Ø 1/2"

### Fume exhaust fittings

Maximum electric fan pressure available Pa 100

Minimum electric fan pressure available Pa 21

Max discharge length Ø60/100 - Hor Co-ax m 10

Max discharge length Ø80/125 - Hor Co-ax m 12

Max discharge length Ø50/50 - Hor Split m 10

Max discharge length Ø60/60 - Hor Split m 32

Max discharge length Ø80/80 - Hor Split m 60

Max discharge length Ø50 - Hor duct m 8

Max discharge length Ø60 - Hor duct m 30

Max discharge length Ø80 - Hor duct m 35

Max discharge length Ø60/100 - Vert Co-ax m 10

Max discharge length Ø80/125 - Vert Co-ax m 12

Max discharge length Ø50/50 - Vert Split m 10

Max discharge length Ø60/60 - Vert Split m 32

Max discharge length Ø80/80 - Vert Split m 60

Max discharge length Ø50 - Vert duct m 8

Max discharge length Ø60 - Vert duct m 30

Max discharge length Ø80 - Vert duct m 35

### Electrical specifications

Voltage-frequency V/Hz 230/50

Max Absorbed Power W 78

Insulation rate IP X4D

### Gas supply

Nominal supply pressure - G20 mbar 20

Heating Max. fan speed - G20 Hz 188

D.H.W Max fan speed - G20 Hz 188

Heating Min. fan speed - G20 Hz 45

D.H.W Min. fan speed - G20 Hz 45

Fuel consumption - G20 m<sup>3</sup>/h 2,49

Nominal Supply pressure - G30 mbar 30



Heating Max. fan speed - G30	Hz	177
D.H.W Max fan speed - G30	Hz	177
Heating Min. fan speed - G30	Hz	45
D.H.W Min. fan speed - G30	Hz	45
Fuel consumption - G30	kg/h	1,85
Nominal Supply pressure - G31	mbar	37
Heating Max. fan speed - G31	Hz	190
D.H.W Max fan speed - G31	Hz	190
Heating Min. fan speed - G31	Hz	45
D.H.W Min. fan speed - G31	Hz	45
Fuel consumption - G31	kg/h	1,83

### Technical parameters for boiler space heaters, boiler combination heaters and cogeneration space heaters

Model		R2KA 24 /40
Condensing boiler	[yes/no]	yes
Low-temperature (**) boiler:	[yes/no]	no
B11 boiler	[yes/no]	no
Cogeneration space heater	[yes/no]	no
If yes, equipped with a supplementary heater	[yes/no]	no
Combination heater	[yes/no]	yes
<b>Rated heat output Prated</b>	kW	22,7
<b>For boiler space heaters and boiler combination heaters: Useful heat output</b>		
At rated heat output and high-temperature regime (*) P <sub>4</sub>	kW	22,70
At 30 % of rated heat output and low-temperature regime (**) P <sub>1</sub>	kW	7,05
<b>For cogeneration space heaters: Useful heat output</b>		
At rated heat output of cogeneration space heater with supplementary heater disabled P <sub>CHP100+Sup0</sub>	kW	-
At rated heat output of cogeneration space heater with supplementary heater enabled P <sub>CHP100+Sup100</sub>	kW	-
<b>For cogeneration space heaters: Electrical efficiency</b>		
At rated heat output of cogeneration space heater with supplementary heater disabled η <sub>el,CHP100+Sup0</sub>	%	-
At rated heat output of cogeneration space heater with supplementary heater enabled η <sub>el,CHP100+Sup100</sub>	%	-
<b>Auxiliary electricity consumption</b>		
At full load elmax	kW	0,04
At part load elmin	kW	0,02
In standby mode PSB	kW	0,004
<b>Seasonal space heating energy efficiency η<sub>s</sub></b>	%	91
Seasonal space heating energy efficiency class		A
For boiler space heaters and boiler combination heaters:		
Useful efficiency		
At rated heat output and high-temperature regime (*) η <sub>4</sub>	%	87,1
At 30 % of rated heat output and low-temperature regime (**) η <sub>1</sub>	%	96,3
<b>For cogeneration space heaters: Useful efficiency</b>		
At rated heat output of cogeneration space heater with supplementary heater disabled η <sub>CHP100+Sup0</sub>	%	-
At rated heat output of cogeneration space heater with supplementary heater enabled η <sub>CHP100+Sup100</sub>	%	-
<b>Supplementary heater</b>		
Rated heat output P <sub>sup</sub>	kW	-
Type of energy input		-
<b>Other items</b>		
Standby heat loss P <sub>stby</sub>	kW	0,1
Ignition burner power consumption P <sub>ign</sub>	kW	0,0





Annual energy consumption $Q_{HE}$	kWh / GJ	15833 / 57
Sound power level, indoors $L_{WA}$	dB	52
<b>For combination heaters:</b>		
D.H.W. energy efficiency class		A
<b>Declared load profile</b>		XL
Daily electricity consumption $Q_{elec}$	kWh	0,146
Annual electricity consumption AEC	kWh	53
<b>Water heating energy efficiency <math>\eta_{wh}</math></b>	%	81
Daily fuel consumption $Q_{fuel}$	kWh	23,929
Annual fuel consumption AFC	GJ	18
<b>Contact details</b>	Tel. +39 0721 9079.1 - fax. +39 0721 9079299 - e-mail: info@radiant.it - http://www.radiant.it	
Name and address of the supplier	RADIANT BRUCIATORI S.p.A. Via Pantanelli, 164/166 - 61025 - Montelabbate (PU)	

(\*) High-temperature regime means 60 °C return temperature at heater inlet and 80 °C feed temperature at heater outlet.

(\*\*) Low temperature means for condensing boilers 30 °C, for low-temperature boilers 37 °C and for other heaters 50 °C return temperature (at heater inlet).

### 2.2.9. TECHNICAL ASSEMBLY

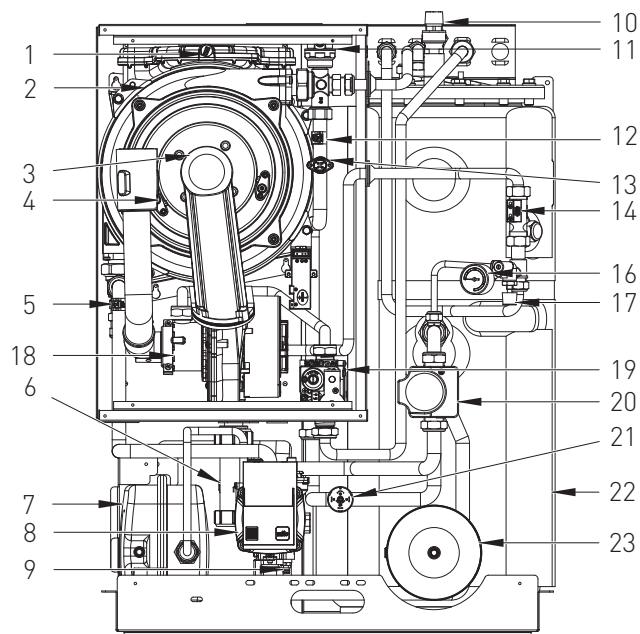

#### KEY

1. FUMES SAFETY THERMOFUSE
2. INTEGRATED HEAT EXCHANGER
3. BURNER UNIT
4. DETECTION ELECTRODE
5. RETURN PROBE
6. CONDENSATE COLLECTION SIPHON
7. EXPANSION TANK HEATING
8. CIRCULATOR
9. SYSTEM DRAINING TAP
10. SAFETY VALVE 8 bar
11. AIR RELIEF VALVE
12. HEATING PROBE
13. SAFETY THERMOSTAT
14. FLOW SWITCH
15. AIR SUCTION TUBE
16. PRESSURE GAUGE
17. SYSTEM FILLING TAP
18. PROPORTIONAL VENTURI
19. GAS VALVE
20. DIVERTER VALVE
21. WATER PRESSURE SWITCH
22. CYLINDER

23. EXPANSION TANK D.H.W.

## 2.2.10. HYDRAULIC BOARD

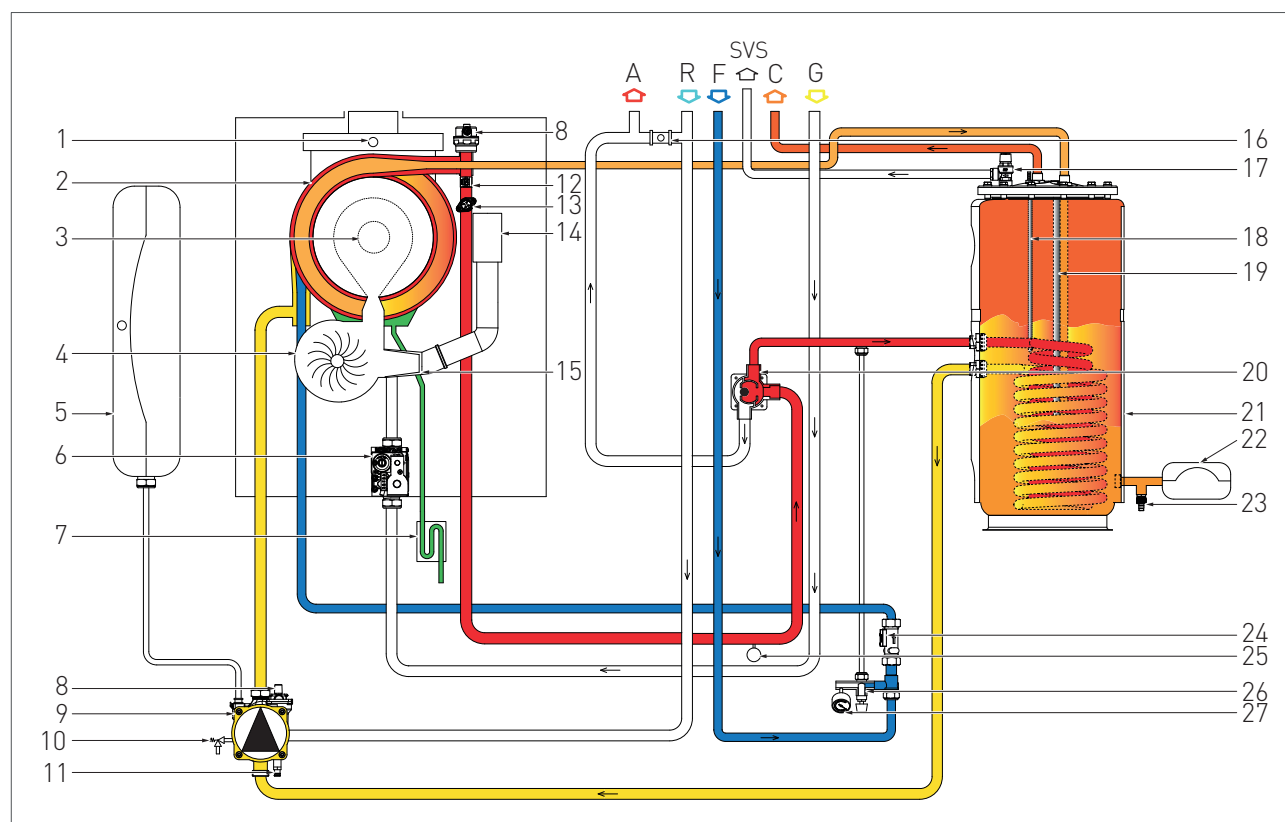

## KEY

- R. HEATING RETURN
- C. DOMESTIC HOT WATER OUTLET
- G. GAS INLET
- SC. CONDENSATE DRAIN
- F. COLD WATER INLET
- A. HEATING FORWARD

- 1. FUMES SAFETY THERMOFUSE
- 2. INTEGRATED HEAT EXCHANGER
- 3. BURNER UNIT
- 4. ELECTRIC FAN
- 5. EXPANSION TANK
- 6. GAS VALVE
- 7. CONDENSATE COLLECTION SIPHON
- 8. AIR RELIEF VALVE
- 9. CIRCULATOR
- 10. SAFETY VALVE 3 bar
- 11. SYSTEM DRAINING TAP
- 12. HEATING PROBE
- 13. SAFETY THERMOSTAT
- 14. AIR SUCTION TUBE
- 15. PROPORTIONAL VENTURI

- 16. BY-PASS
- 17. SAFETY VALVE 8 bar
- 18. DOMESTIC CIRCUIT PROBE
- 19. ANODE
- 20. DIVERTER VALVE
- 21. CYLINDER
- 22. EXPANSION TANK D.H.W.
- 23. CYLINDER DRAINING TAP
- 24. FLOW SWITCH
- 25. WATER PRESSURE SWITCH
- 26. SYSTEM FILLING TAP
- 27. PRESSURE GAUGE

### 2.2.11. 3-WAY VALVE OPERATION

Important: The working position of the 3-way valve is indicated by the color (Red or Blue) visible in the inside of the valve. (see 'C' - fig. 1).

- › The RED color (with C-A) indicates the operation in Heating mode.
- › The BLUE color (with C-B) indicates the operation in the Domestic Hot water mode.



## 2.2.12. WIRING DIAGRAM

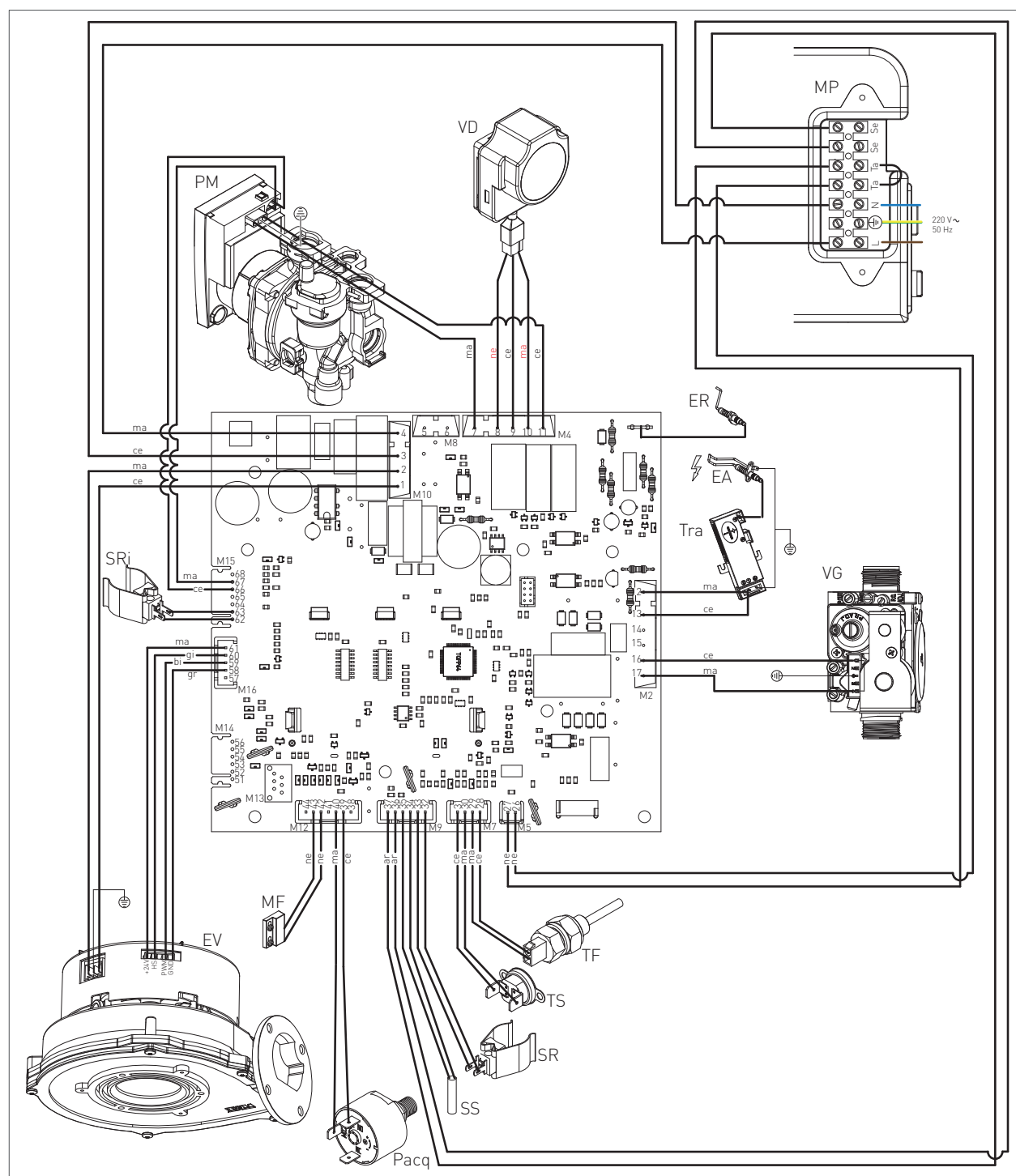

ER: DETECTION ELECTRODE  
EA: START-UP ELECTRODE  
PM: MODULATING PUMP  
VG: GAS VALVE  
TRA: START-UP TRANSFORMER  
TF: FUMES THERMOFUSE (102°C)  
VD: DIVERTER VALVE

TS: SAFETY THERMOSTAT  
PACQ: WATER PRESSURE SWITCH  
MF: MICRO-FLOW SWITCH  
SR: HEATING PROBE  
SS: DOMESTIC CIRCUIT PROBE  
EV: ELECTRIC FAN  
SRI: RETURN SENSOR

MP: PANEL TERMINAL  
SE: EXTERNAL PROBE  
TA: ENVIRONMENT THERMOSTAT  
L: LINE  
N: NEUTRAL  
NE: BLACK

CE: BLUE  
MA: BROWN  
AR: ORANGE  
GI: YELLOW  
BI: WHITE  
GR: GREY

### 2.2.13. ACCESSING THE BOILER

All maintenance and control operations require the boiler casing panels to be removed.

To intervene on boiler casing, please proceed according to the following instructions:

- › remove the top cover '1' (fig. 1) by pulling it vertically;
- › grab panel '2' (fig. 1) from the upper side and rotate it downwards. To remove the panel completely, first dismantle the electronic PCB front panel from the support brackets. Then remove the fixing screws from the inner part of the panel.
- › Grab panel '3' (fig. 1) from the upper side and rotate it downwards. To remove the panel, unscrew the fixing screws from the inner part of the panel.
- › Remove panels '4' and '5', by unscrewing the fixing screws from the inner part of the panel.

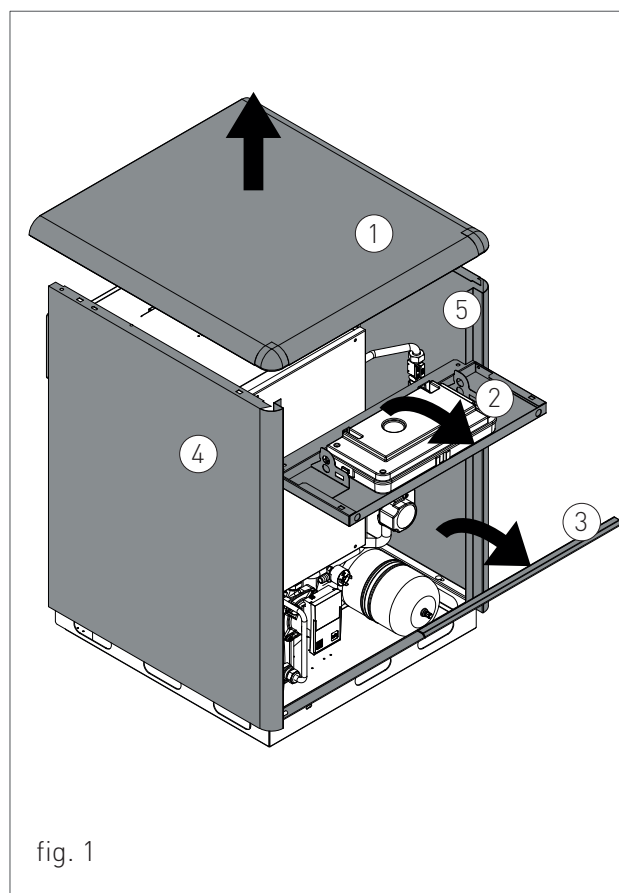

## 2.2.14. ACCESSING THE ELECTRONIC BOARD

In order to intervene on the wirings of the control panel, please proceed as follows:



### DANGER

*Cut off the voltage from the main switch.*

- › Follow the procedure described at chapter 'ACCESSING THE BOILER' and rotate panel '2' (fig 1);
- › Unscrew the four fixing screws (see A - fig. 2);
- › remove the carter upwards (see B - fig. 2);

To access the terminal block, proceed as follows:

- › Grab both control panel supporting brackets (see C - fig. 2) by widening them and move the control panel from position '1' to position '2' (see detail, C - fig. 2)
- › lift the panel by rotating it upwards;
- › unscrew both screws and remove the plate (see D, fig. 2).

fig. 2

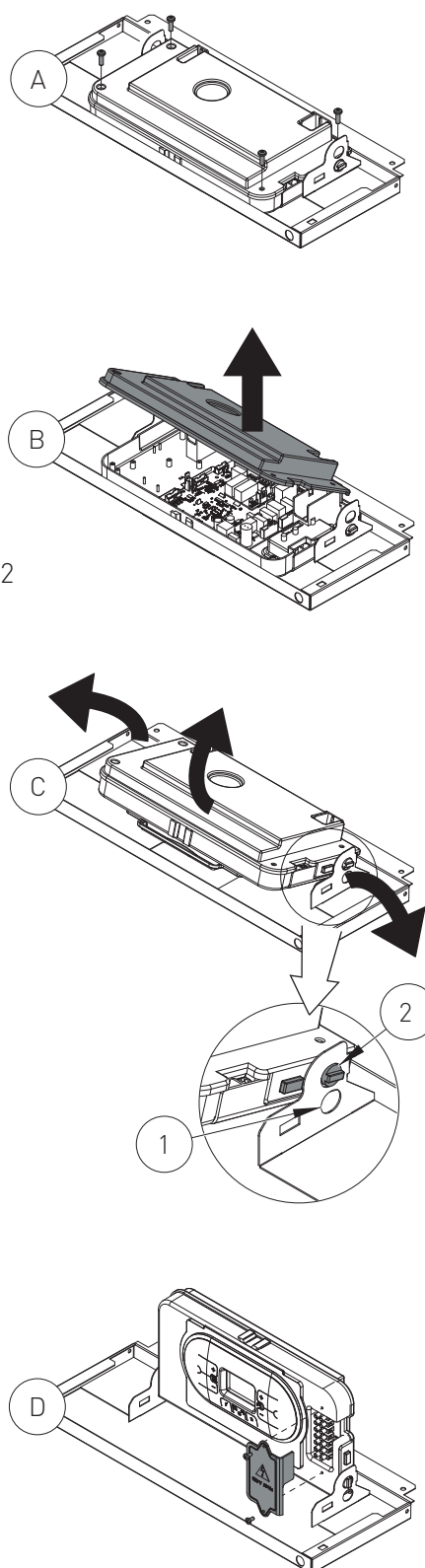

### 2.2.15. SYSTEM EMPTYING

#### HEATING SYSTEM EMPTYING

Whenever you need to empty the system, proceed as follows:

- › switch the boiler to “WINTER” mode and activate it;
- › turn off the main power supply switch;
- › wait for the boiler to cool down;
- › connect a flexible tube to the system emptying outlet and connect the other end of the tube to a suitable discharge;
- › turn the discharge tap of the system ‘RS’ (fig. 1);
- › open the relief valves of the radiators starting from the one at the top and continuing downwards;
- › after draining out all water, close the relief valves of the radiators and the emptying tap.

#### EMPTYING THE DOMESTIC SYSTEM

If there is freezing risk, you have to empty the domestic system as follows:

- › close the main supply tap of the water supply network;
- › Joint the water draining pipe and open the cylinder draining tap ‘RB’ (fig.2)
- › open all cold and hot water taps;
- › after completing all operations, close the cylinder draining tap ‘RB’ (fig.2) and all previously opened water taps.

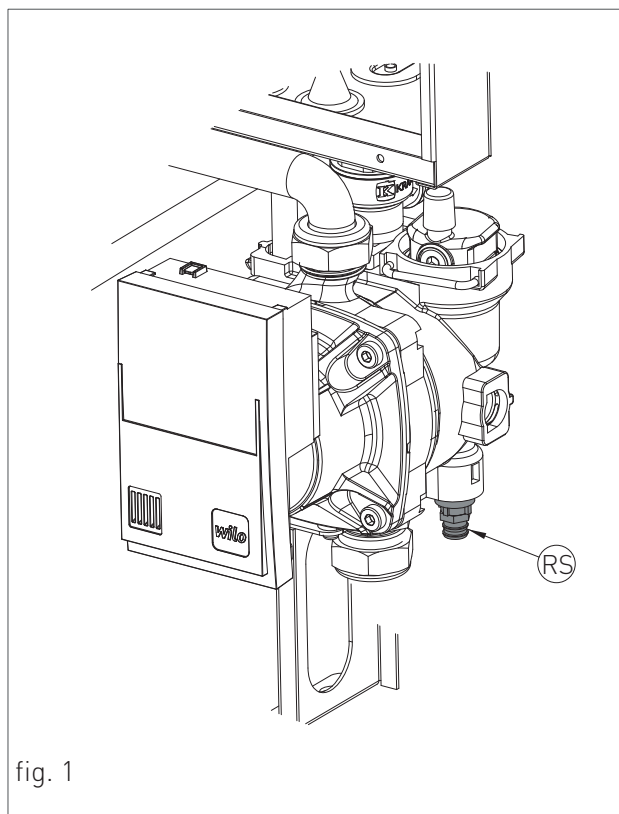

fig. 1

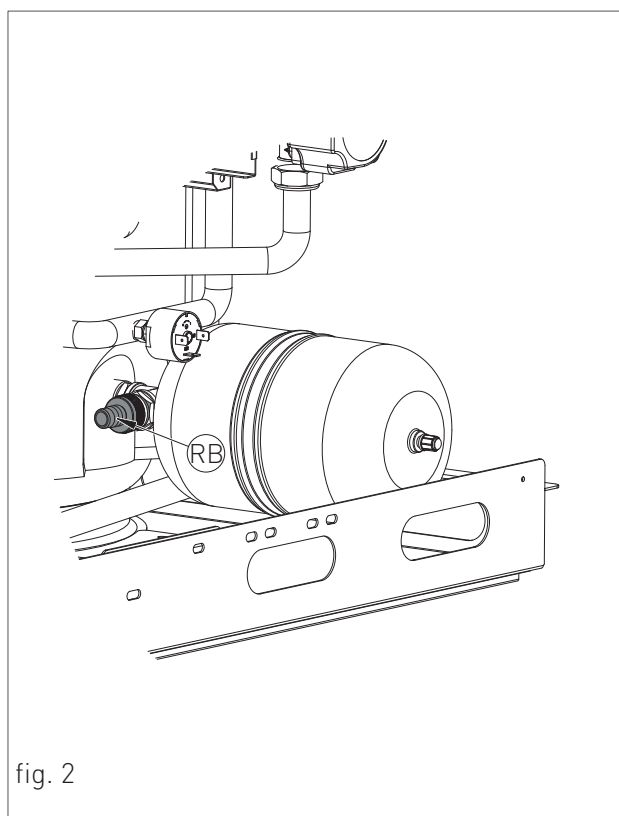

fig. 2



## 2.2.16. BOILER MAINTENANCE

It's necessary to check and replace the magnesium anode after a year or more frequently if the quality and the water worn require it.

In order to check the anode functioning it's necessary to open the cap 'B' (fig.1) situated on the top of the boiler.

If during this operations there is a water leak, the anode has to be replaced because worn.

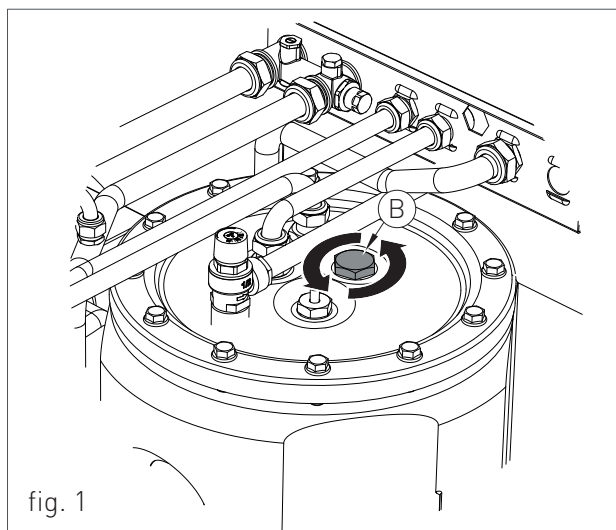



fig. 1



## 2. MAINTENANCE

### 2.2.17. FAULT SIGNALLING CODES

To view the last 5 fault signalling codes chronologically, starting with the most recent one, activate the 'OFF' mode by pressing the FUNCTION key and hold the key INFO for 5 seconds. Use keys and of the heating circuit to scroll through the list of saved faults. To reset the fault history press the RESET key. To exit display mode press the INFO key.

CODE	FAULT	POSSIBLE CAUSE	SOLUTION	RESET
E01	FLAME BLOCK	NO FLAME LIGHT UP		MANUAL RESET (PRESS THE RESET  KEY).
		GAS MISSING;	CHECK THE ADDUCTION NETWORK;	
		MASS OR BROKEN START-UP ELECTRODE;	REPLACE IT;	
		GAS VALVE BROKEN;	REPLACE IT;	
		SLOW LIGHT UP TOO LOW ADJUSTMENT;	ADJUST MINIMUM OR SLOW LIGHT UP;	
		VALVE INFEEED PRESSURE TOO HIGH (ONLY FOR GPL BOILERS).	CHECK THE MAXIMUM ADJUSTMENT PRESSURE	
		WITH FLAME LIGHT UP		
		NEUTRAL AND PHASE INVERTED POWER SUPPLY;	PROPERLY CONNECT THE POWER SUPPLY;	
		DETECTION ELECTRODE BROKEN;	REPLACE IT;	
		DETECTION ELECTRODE CABLE DISCONNECTED.	CHECK THE WIRING.	
		ELECTRICAL CURRENT PHASE-PHASE	IF THE TENSION MEASURES BETWEEN NEUTRAL AND GROUND IS ALMOST EQUAL TO THE ONE MEASURED BETWEEN PHASE AND GROUND, YOU HAVE TO INSTALL A PHASE-PHASE TRANSFORMER KIT (COD. 88021LA)	

2Codici segnalazione anomalie\_MIAH4\_EN



## 2. MAINTENANCE

CODE	FAULT	POSSIBLE CAUSE	SOLUTION	RESET
E16	<b>ELECTRIC FAN</b>	ELECTRIC FAN BOARD BROKEN;	REPLACE IT;	AUTOMATIC.
		ELECTRIC FAN BROKEN;	REPLACE IT;	
		FAULTY POWER SUPPLY CABLE.	REPLACE IT.	
E18	<b>INSUFFICIENT CIRCULATION</b>	EXCHANGER OBSTRUCTED;	CLEAN OR REPLACE THE EXCHANGER;	AUTOMATIC.
		CIRCULATOR BROKEN OR DIRTY IMPELLER.	CLEAN THE IMPELLER OR REPLACE THE CIRCULATOR.	
E21	<b>GENERAL INTERNAL BOARD ERROR</b>	INCORRECT SIGNAL RECOGNITION BY THE MODULATION BOARD MICRO-PROCESSOR.	IF THE MODULATION BOARD DOES NOT RESET THE ERROR AUTOMATICALLY, REPLACE IT.	AUTOMATIC.
E22	<b>PARAMETERS PROGRAMMING REQUEST</b>	MICRO-PROCESSOR MEMORY LOSS.	PARAMETERS REPROGRAMMING.	MANUAL RESET (CUT OFF THE TENSION).
E35	<b>RESIDUAL FLAME</b>	FAULTY DETECTION ELECTRODE;	CLEAN IT OR REPLACE IT;	MANUAL RESET (PRESS THE RESET  KEY).
		FAULTY DETECTION ELECTRODE CABLE;	REPLACE IT;	
		FAULTY MODULATION BOARD.	REPLACE IT.	
E40	<b>SUPPLY VOLTAGE</b>	SUPPLY VOLTAGE OFF THE OPERATION RANGE ( $\leq 160$ VOLTS).	CHECK THE POWER SUPPLY NETWORK (THE ERROR DEACTIVATES AUTOMATICALLY AS SOON AS THE SUPPLY VOLTAGE FALLS BACK WITHIN THE REQUESTED LIMITS).	AUTOMATIC.



## 2.2.18. ACTIVE FUNCTIONS SIGNALLING CODES

CODE	FUNCTION	DESCRIPTION
F07	<b>CHIMNEY SWEEP ACTIVE</b>	YOU CAN ACTIVATE IT BY HOLDING FOR 7 SECONDS THE RESET  KEY AND YOU CAN DEACTIVATE IT BY TURNING OFF THE BOILER. THIS FUNCTION BRINGS THE BOILER TO ITS MINIMUM AND MAXIMUM HEATING POWER FOR 15 MINUTES DEACTIVATING THE MODULATION FUNCTION. GENERALLY USED FOR PERFORMING THE COMBUSTION AND CALIBRATION TESTS.
F08	<b>HEATING CIRCUIT ANTI-FREEZE</b>	IT ACTIVATES AUTOMATICALLY WHEN THE HEATING PROBE DETECTS A TEMPERATURE OF 12°C. THE BOILER OPERATES AT MINIMUM GAS PRESSURE WITH THE DIVERTER VALVE SET TO 'WINTER' MODE. IT DEACTIVATES WHEN THE HEATING FLOW WATER TEMPERATURE REACHES THE 30°C AND, IN PRESENCE OF A RETURN SENSOR, WHEN THE HEATING RETURN WATER TEMPERATURE REACHES THE 20°C.
F09	<b>D.H.W CIRCUIT ANTI-FREEZE</b>	THE FUNCTION IS AUTOMATICALLY ENABLED WHEN THE D.H.W SENSOR DETECTS A TEMPERATURE OF 4 °C. THE BOILER OPERATES AT MINIMUM GAS PRESSURE WITH THE DIVERTER VALVE IN THE 'SUMMER' POSITION. THE FUNCTION IS DISABLED WHEN THE TEMPERATURE DETECTED BY THE SENSOR IS 8 °C IN THE D.H.W CIRCUIT.
F28	<b>ANTI-LEGIONELLA</b>	THE FUNCTION IS ACTIVATED FOR THE FIRST TIME, 60 MINUTES AFTER THAT THE BOILER HAS BEEN ELECTRICALLY POWERED. STARTING FROM THAT MOMENT IT COMES AUTOMATICALLY INTO OPERATION EVERY 7 DAYS, BRINGING THE HOT WATER TEMPERATURE OF THE STORAGE CYLINDER UP TO 60°C. THIS FUNCTION IS ENABLED INDEPENDENTLY FROM THE CONTACT TO THE CYLINDER CLOCK, PROVIDING THAT THE RELATIVE PARAMETER (P15) IS ENABLED.
F33	<b>SYSTEM AIR RELEASE CYCLE</b>	IT ACTIVATES AUTOMATICALLY AT FIRST BOILER START-UP, PERFORMING FOR 5 MINUTES A SERIES OF CYCLES DURING WHICH THE PUMP IS ACTIVATED FOR 40 SECONDS AND DEACTIVATED FOR 20 SECONDS. REGULAR OPERATION IS ALLOWED ONLY AFTER THIS FUNCTION IS COMPLETED. IT CAN ALSO ACTIVATE DURING NORMAL BOILER OPERATION, IF THE WATER PRESSURE SWITCH CONFIRMATION IS MISSING, WHEN THE CONTACT IS RE-CLOSED, A 2 MINUTES RELEASE CYCLE WILL BE PERFORMED.

### 2.2.19. GAS TYPE TRANSFORMATION



#### ATTENTION

*Make sure that the gas adduction tube is suitable for the new type of fuel with which the boiler is supplied.*

- › loosen the two screws '1' (fig.1) from the fastening bush, and remove the air suction tube;
- › unscrew the tube coupling that connects the gas valve to venturi;
- › unscrew the three fastening screws '2' (fig.1) of the venturi 'V' (fig.1) using a 10 key, as shown in figure 2;
- › remove the two screws '3' (fig.3) and apply pressure on the rear side of venturi 'C' (fig.3);
- › replace the body venturi with the one suitable for the type of supply gas (cod. 30-00124 for methane / cod. 30-00170 for GPL) and make sure the tooth 'D' (fig.3) is adjusted downwards on the aluminium ring nut (see fig.3);
- › remount the components following the demounting operations in reverse making sure that gasket 'G' is re-assembled as shown in fig.1;
- › set the boiler to operate with the new type of gas, changing the value of the parameter P02 'GAS TYPE SELECTION' from the control panel (see chapters 'DIGITECH CS PARAMETERS TABLE' and 'ACCESSING AND PROGRAMMING THE PARAMETERS');
- › adjust the CO<sub>2</sub> combustion value as indicated in chapter 'CO<sub>2</sub> VALUE CHECK AND CALIBRATION'.

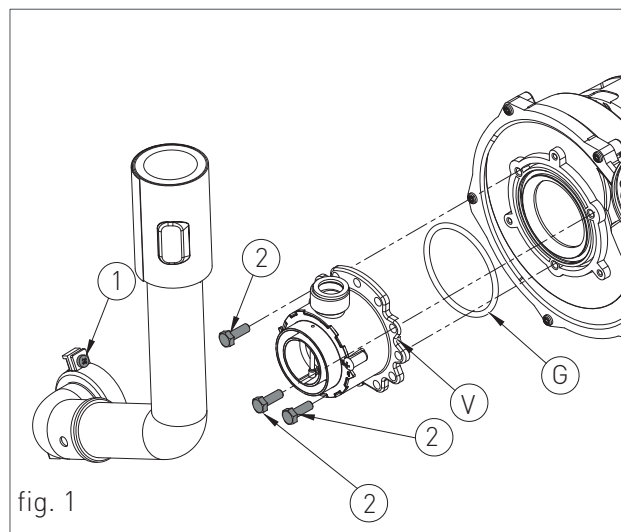

fig. 1

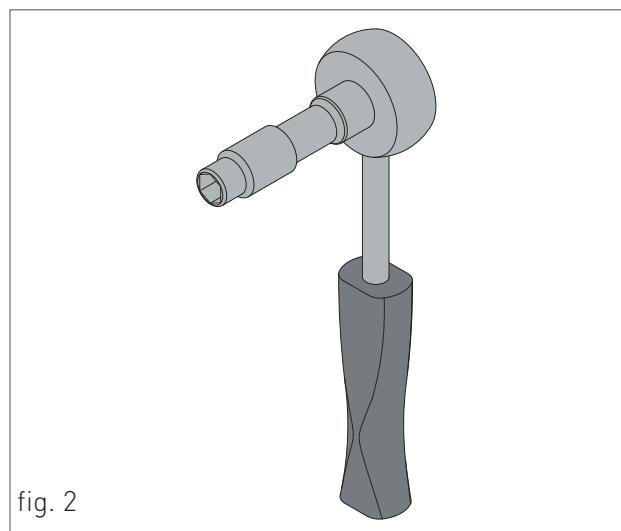

fig. 2

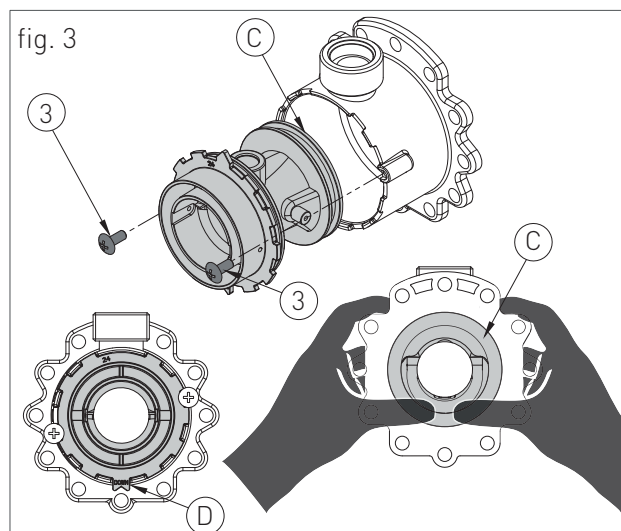

fig. 3



## 3. USER SECTION

The operations described in this section are addressed to all those who will use the machine. The machine must be used and accessed only by qualified operators that fully read and understood the User section, paying particular attention to the warnings.

## 3.1. USE

### 3.1.1. GENERAL USE WARNINGS

**WARNING**

*Before starting the boiler the User must make sure that the First start-up certificate has the stamp of the technical Support Centre proving the testing and the first start-up of the boiler.*

**WARNING**

*To validate the warranty, the boiler must be started by a technical Support Centre authorized by RADIANT no later than 30 days from the date of installation.*

**WARNING**

*In order to take advantage of the guarantee provided by the manufacturer, the customer should carefully and exclusively observe the instructions given in the USER section of the manual.*

**ATTENTION**

*This machine may be used only for the purpose for which it has been designed: heat water to a temperature below boiling point at atmospheric pressure. Any other use is considered wrong and dangerous. The manufacturer is excluded from any contractual or out of contract responsibility for damage caused to people, animals or property due to incorrect use.*

**DANGER**

*The boiler should not be used by persons (including children) with reduced physical, sensory or mental capacities or without suitable knowledge or experience unless they are instructed on the device use or monitored by a person responsible for their safety.*

**DANGER**

*DO NOT obstruct the air vents of the location in which the gas device is installed to prevent the formation of toxic explosive mixes.*

**DANGER**

*If you sense a gas odour in the location in which the boiler is installed, proceed as follows:*

- › DO NOT use electrical switches, the telephone or any other device that might generate electrical discharges or sparks;
- › Immediately open all doors and windows to create an air exchange that can quickly clean the location;
- › Close the gas valves;
- › Request immediate intervention of qualified staff.

**DANGER**

*The use of the electrical power boiler implies respecting some fundamental rules such as:*

- › DO NOT touch the device with wet and/or humid parts and/or with bare feet;
- › DO NOT pull the electrical cables;
- › DO NOT leave the device exposed to atmospheric agents (rain, sun, etc.) unless specifically intended;
- › in case of cable damage, turn off the device and contact qualified professional staff to replace it.



### 3.1.2. CONTROL PANEL

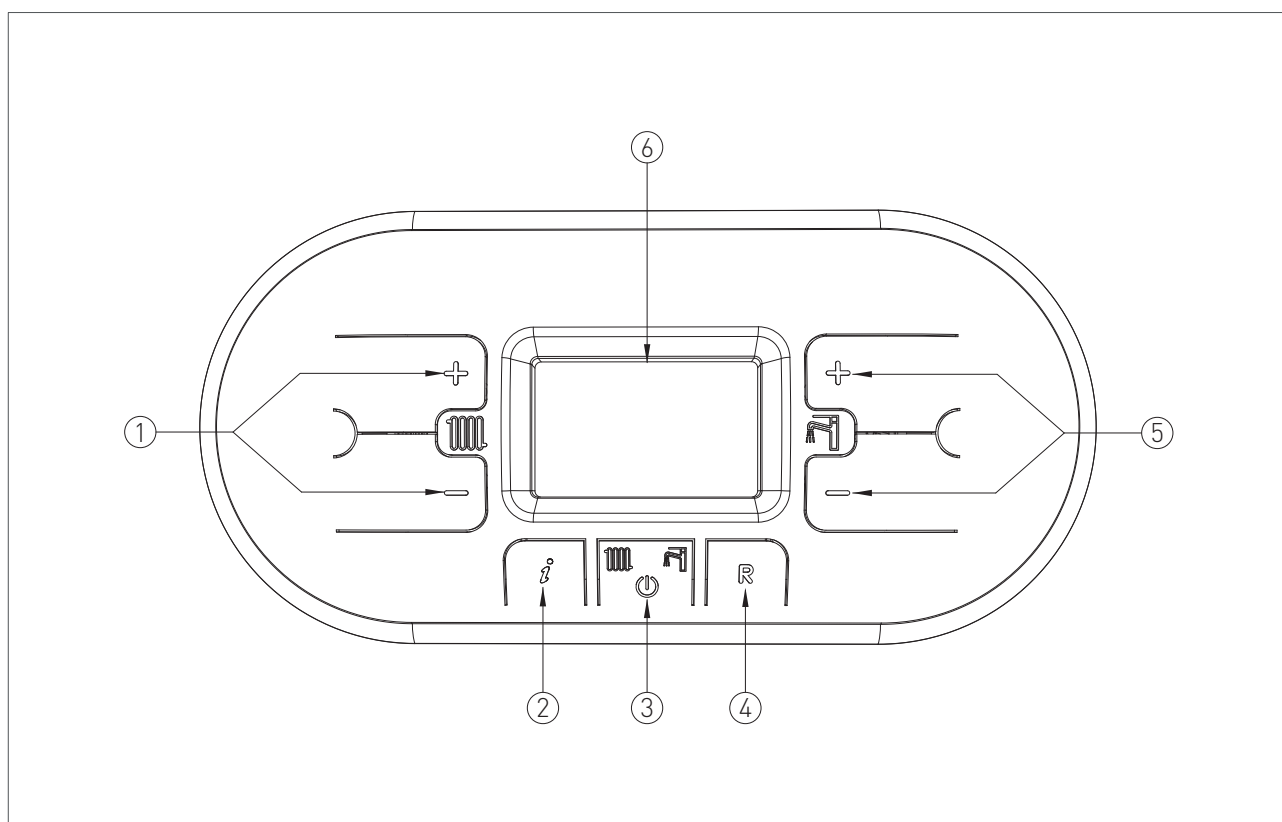

#### KEY

#### 6. DISPLAY

1. HEATING TEMPERATURE ADJUSTMENT KEYS
2. INFO KEY: PRESS ONCE TO VIEW THE TEMPERATURES AND OTHER INFORMATION (see chapter 'INFO MENU DISPLAY') - HOLD FOR 5 SECONDS, IN OFF OPERATING MODE, TO VIEW THE LAST 5 FAULTS
3. OPERATING MODE SELECTION KEY: SUMMER / ONLY HEATING / WINTER / OFF
4. RESET KEY: FAULTS RESET - CHIMNEY SWEEP FUNCTION ACTIVATION (HOLD FOR 7 SECONDS)
5. DOMESTIC HOT WATER TEMPERATURE ADJUSTMENT KEY / HOLD THE KEYS AT THE SAME TIME FOR 5 SECONDS TO ACTIVATE DISPLAY BACK LIGHT FOR 10 MINUTES

#### 3.1.3. DISPLAY ICONS



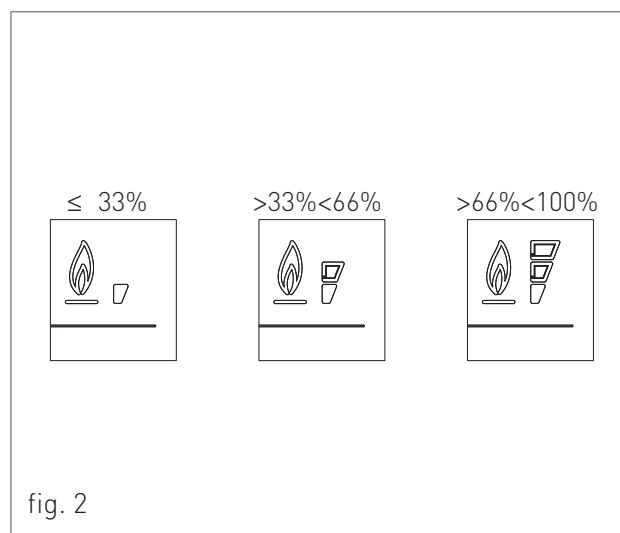
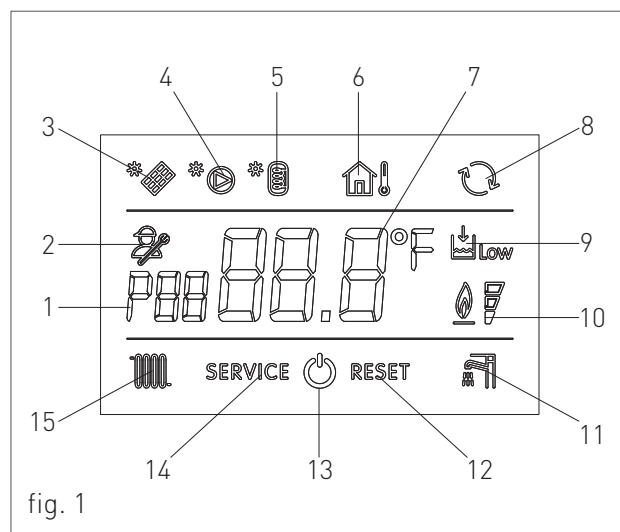

##### KEY

1. INDICATION OF PARAMETER NUMBER OR DISPLAYED INFO CODE
2. PARAMETERS PROGRAMMING FUNCTION ACTIVE
3. SIGNALLING CONNECTED SOLAR BOARD / SOLAR COLLECTOR TEMPERATURE DISPLAY (d5)
4. SOLAR PUMP ACTIVE
5. BOILER LOWER TEMPERATURE DISPLAY (d6) / BOILER UPPER TEMPERATURE DISPLAY (d7)
6. EXTERNAL PROBE INSTALLED / EXTERNAL PROBE TEMPERATURE (d1)
7. TEMPERATURE DISPLAY / SET POINT / PARAMETER VALUE
8. OPEN THERM COMMUNICATION PRESENT (REMOTE CONTROL / AREA CONTROL UNIT)
9. INSUFFICIENT SYSTEM WATER PRESSURE SIGNALLING
10. FLAME PRESENT SIGNALLING / IT ALSO INDICATES, ON 3 PERCENTAGE LEVELS, THE MODULATING POWER LEVEL OF THE BOILER (fig.2)
11. OPERATION IN DOMESTIC MODE ENABLED
12. ERROR DISPLAY THAT CAN BE RESET
13. OFF OPERATING MODE
14. ERROR DISPLAY THAT CAN NOT BE RESET
15. OPERATION IN HEATING MODE ENABLED











### 3.1.4. INFO MENU DISPLAY DATA



To view the boiler data from info menu you just have to press the INFO  key. The info code will be displayed on the left side of the screen and its relative value will be displayed on the centre of the screen. Use keys  and  of the heating circuit  to scroll through the list of displayed data. To exit display mode press the INFO  key.

#### LIST OF DISPLAYED DATA

INFO CODE	ICON	DESCRIPTION
d0		DOMESTIC CIRCUIT PROBE TEMPERATURE
d1		EXTERNAL PROBE TEMPERATURE
d2		FAN SPEED
d3		BOTTOM AREA PROBE TEMPERATURE [IF AREA BOARD INSTALLED]
d4		RETURN PROBE TEMPERATURE
d5		SOLAR COLLECTOR TEMPERATURE [IF SOLAR BOARD INSTALLED] (SCS)
d6		SOLAR BOILER TEMPERATURE (BOTTOM) [IF SOLAR BOARD INSTALLED] (SBSI)
d7		SOLAR BOILER TEMPERATURE (TOP) [IF SOLAR BOARD INSTALLED] (SBSS)
d8		SOLAR COLLECTOR PROBE TEMPERATURE 2 [IF SOLAR BOARD INSTALLED] (SCS2)
d9		EXTRA SOLAR BOILER TEMPERATURE [IF SOLAR BOARD INSTALLED] (SBS3)

## WINTER MODE

In this mode the boiler meets the demands of heating and of domestic hot water.

To switch the boiler to WINTER operating mode, press the function key , the symbols  and  will appear fixed on the display, indicating that the function is enabled.

Whenever heating energy and domestic hot water are needed the automatic start-up system will start the burner; this is indicated by displaying the symbol '🔥' and '🔧' blinking.

## ADJUSTING THE HEATING TEMPERATURE



You can adjust the temperature using keys '+' and '-' of the heating circuit .

- press key **⊖** to decrease the temperature.
- press key **⊕** to increase the temperature.

The heating temperature adjustment field ranges from 30 °C to 80 °C (25 °C – 45 °C for floor systems).

## DOMESTIC HOT WATER TEMPERATURE ADJUSTMENT

You can adjust the temperature using keys '+' and '-' of the domestic circuit .

- press key  to decrease the temperature.
- press key  to increase the temperature.



The hot domestic water temperature adjustment field ranges from 35 °C to 60 °C.

## OFF MODE

In this mode the boiler no longer meets the heating and domestic hot water demands, the anti-freeze,



pump anti-locking and diverter valve anti-locking systems still remain active.

To switch the boiler to OFF operating mode, press the function key , the symbol  will appear fixed on the display, indicating that the function is enabled (for non condensing models will appear the message 'OFF').

If the boiler was previously running, it will be turned off and the post-ventilation and post-circulation functions will be enabled.

If you have to deactivate the boiler for a long period of time, proceed as follows:

- › contact the Technical support centre that will empty the water system, where no anti-freeze is intended, and will cut off the power, water and gas supply.
- › Or leave the boiler in OFF operating mode keeping active the electrical and gas supplies so that the anti-freeze function may activate.

### 3.1.7. INFORMATIONAL NOTE ON ANTI-FREEZE FUNCTION

The boiler is protected against freezing thanks to the electronic board preparation with functions that start the burner and heat the concerned parts when their temperature goes below the minimum pre-set values.



#### WARNING

*This function is available only if:*

- › the boiler is powered;
- › the gas supply is open;
- › the pressure of the system is proper;
- › the boiler is not blocked.

#### 3.1.8. SYSTEM FILLING

To restore the water pressure inside the system open the loading tap "R" (fig. 1) and make sure using pressure gauge "M" (fig. 1), that the system pressure reaches 1.2 bar, which corresponds to the middle part of the green zone 'ZV' (fig. 2);

After performing this operation, make sure that the loading tap "R" (fig. 1) is properly closed.

After the water pressure reset the boiler will automatically perform a 2 minutes system relief cycle. Throughout this function the display will show the code "F33". The boiler can work normally only after completing the operation.

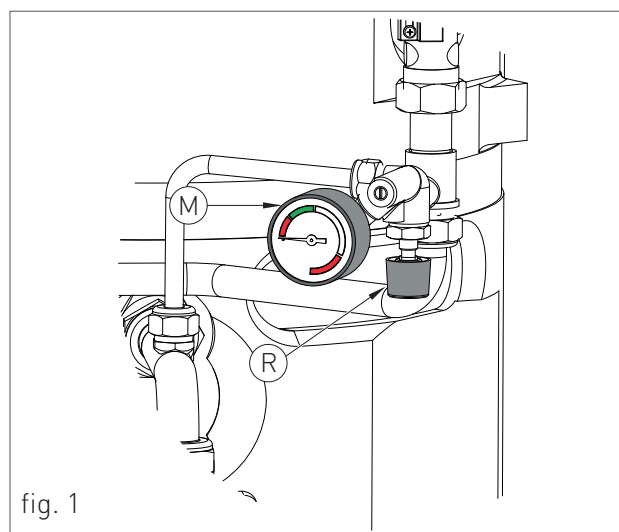

fig. 1

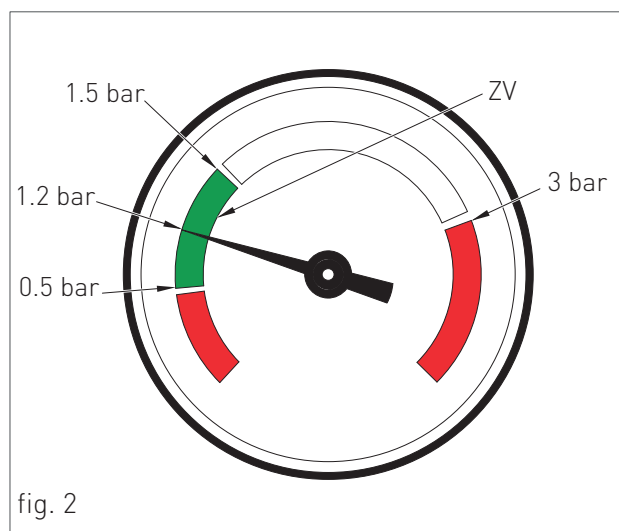



fig. 2



### 3.1.9. FAULT SIGNALLING CODES

The boiler might signal some faults by displaying a code. Below you have a list of the codes and of the operations to be performed in order to unlock the boiler.

CODE	ICON	FAULT	INTERVENTION
E01	RESET	FLAME BLOCK	<p>MAKE SURE THAT THE BOILER AND CONTACTOR GAS VALVES ARE OPEN.</p> <p>PRESS THE RESET  BUTTON ON THE CONTROL PANEL TO RESET THE FAULT, AS SOON AS THE ERROR CODE DISAPPEARS FROM THE DISPLAY, THE BOILER WILL START AUTOMATICALLY.</p> <p>IF THE BLOCK PERSISTS CONTACT THE TECHNICAL SUPPORT CENTRE.</p>
E02	RESET	SAFETY THERMOSTAT (95 °C)	CONTACT THE TECHNICAL SUPPORT CENTRE.
E03	RESET	FUMES SAFETY THERMOFUSE (102 °C)	CONTACT THE TECHNICAL SUPPORT CENTRE.
E04	 Low	WATER MISSING IN THE SYSTEM	<p>IF THE SYSTEM PRESSURE IS BELOW 1.2 BAR, FILL THE SYSTEM AS DESCRIBED IN CHAPTER "SYSTEM FILLING".</p> <p>IF THE BLOCK PERSISTS CONTACT THE TECHNICAL SUPPORT CENTRE.</p>
E05	SERVICE	HEATING PROBE	CONTACT THE TECHNICAL SUPPORT CENTRE.
E06	SERVICE	DOMESTIC CIRCUIT PROBE	CONTACT THE TECHNICAL SUPPORT CENTRE.
E15	SERVICE	RETURN PROBE	CONTACT THE TECHNICAL SUPPORT CENTRE.
E16	SERVICE	ELECTRIC FAN	CONTACT THE TECHNICAL SUPPORT CENTRE.
E18	SERVICE	INSUFFICIENT CIRCULATION	CONTACT THE TECHNICAL SUPPORT CENTRE.
E21	SERVICE	GENERAL INTERNAL BOARD ERROR	<p>CUT OFF THE POWER SUPPLY FROM THE MAIN SWITCH AND THEN RESTORE IT, AS SOON AS THE ERROR CODE DISAPPEARS, THE BOILER WILL RESTART AUTOMATICALLY.</p> <p>IF THE BLOCK PERSISTS CONTACT THE TECHNICAL SUPPORT CENTRE.</p>



### 3. USE

CODE	ICON	FAULT	INTERVENTION
E22	SERVICE	PARAMETERS REQUEST	PROGRAMMING CUT OFF THE POWER SUPPLY FROM THE MAIN SWITCH AND THEN RESTORE IT, AS SOON AS THE ERROR CODE DISAPPEARS, THE BOILER WILL RESTART AUTOMATICALLY.  IF THE BLOCK PERSISTS CONTACT THE TECHNICAL SUPPORT CENTRE.
E35	RESET	RESIDUAL FLAME	PRESS THE RESET  BUTTON ON THE CONTROL PANEL TO RESET THE FAULT, AS SOON AS THE ERROR CODE DISAPPEARS FROM THE DISPLAY, THE BOILER WILL START AUTOMATICALLY.
E40	SERVICE	SUPPLY VOLTAGE	CONTACT THE TECHNICAL SUPPORT CENTRE.





### 3.1.10. ACTIVE FUNCTIONS SIGNALLING CODES

CODE	FUNCTION	INTERVENTION
F08	<b>H E A T I N G A N T I - F R E E Z E F U N C T I O N A C T I V E</b>	WAIT UNTIL THE OPERATION IS COMPLETED
F09	<b>D.H.W C I R C U I T A N T I - F R E E Z E F U N C T I O N A C T I V E</b>	WAIT UNTIL THE OPERATION IS COMPLETED
F28	<b>A N T I - L E G I O N E L L A F U N C T I O N</b>	WAIT UNTIL THE OPERATION IS COMPLETED
F33	<b>S Y S T E M A I R R E L E A S E C Y C L E I N P R O G R E S S</b>	WAIT UNTIL THE OPERATION IS COMPLETED



#### 3.1.11. MAINTENANCE

To ensure proper boiler safety and efficiency, please contact RADIANT technical support network to check the device every year.

An accurate maintenance should improve system management.

#### 3.1.12. COVER CLEANING

Clean the cover of the device using a wet cloth and come neutral soap.



##### **WARNING**

*DO NOT use abrasive or powder detergents as they might damage the plastic cover and control elements.*

#### 3.1.13. DISPOSAL

The boiler and all its accessories must be differentiated, suitably disposed of in accordance with the standards in force.



The use of the symbol WEEE (Waste Electrical and Electronic Equipment) shows that this

product can not be dismantled as domestic waste. Proper dismantle of this product helps preventing potentially negative consequences on human health and environment.





**RADIANT BRUCIATORI s.p.a.**

Via Pantanelli, 164/166 - 61025 Loc. Montelabbate (PU)

Tel. +39 0721 9079.1 • fax. +39 0721 9079279

e-mail: [info@radiant](mailto:info@radiant) • Internet: <http://www.radiant.it>